

### Using a blind hem:

#### Why use a blind hem?

So you don't get a line of visible stitches on your fabric when shortening. Great for trousers, tailored garments and even your curtains.

#### Top Tips:

- ◇ First, I'd suggest matching your thread colour to your fabric as best as possible as the thread may show on certain fabrics.
- ◇ Secondly, it is all about the fold! If you don't fold the fabric correctly the magic won't happen. You need to fold the fabric twice to create a backwards S shape.
- ◇ Final tip—get the position of those stitches perfect! You need the peaks of the zigzag to just catch the very edge of that fold—too deep and you will have visible stitch lines on your fabric. Adjust the width controls align.

**If choosing between two thread colours:  
GO DARKER!**

**Have a practice first!**

#### Materials

- ◆ Sewing Machine—with a blind hem stitch
- ◆ Sewing kit (pins, threads, scissors)
- ◆ Item that needs to be hemmed
- ◆ Iron

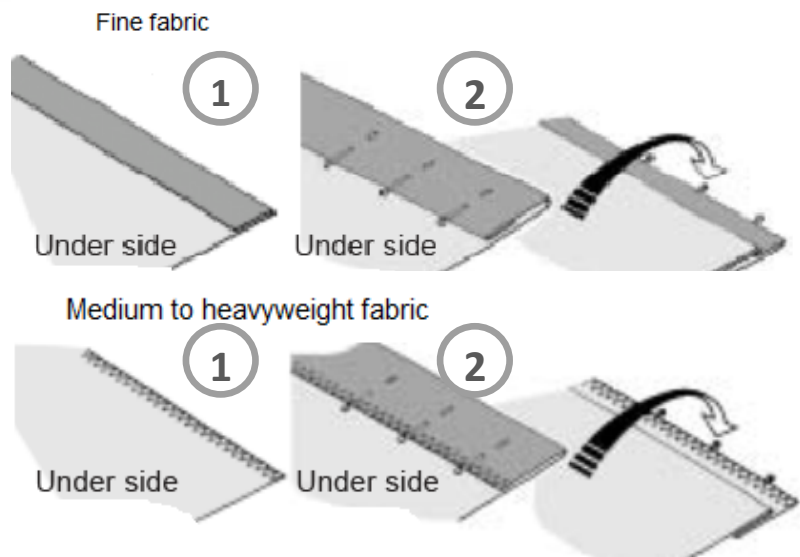

### Sewing a blind hem:

1. First, finish the raw edge—do this by turning it under on fine fabrics or overcasting it on medium to heavyweight fabrics. Then turn the hem up the required depth, press an pin in place.
2. Now fold the fabric as illustrated with the wrong side up.
3. Place the fabric under the foot. Turn the handwheel towards you by hand until the needle swings fully to the left. It should just pierce the fabric fold and the guide just rests against the fold.
4. Sew slowly, guiding the fabric carefully along the edge of the guide.

5. When completed, the stitching is almost invisible on the right side of the fabric.

