

The background of the top half of the page is white, overlaid with a large, bold 'X' shape. The 'X' is formed by two intersecting yellow rectangles. The text 'JOHN LEWIS & PARTNERS' is centered over this graphic.

# JOHN LEWIS & PARTNERS

Wooden play kitchen

Thank you for purchasing this toy.  
Please read the instructions and warnings  
carefully before use.

# Assembly instructions

Adult assembly of this product is required.  
Cross head screwdriver required for assembly.

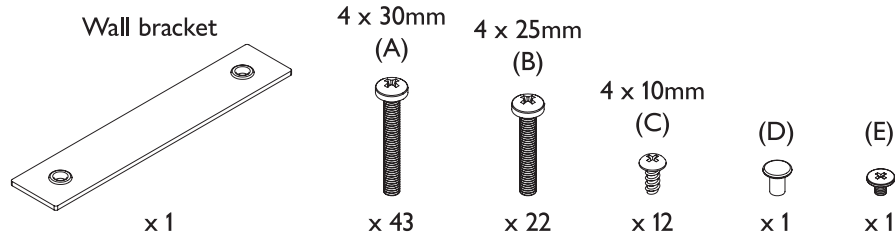

# Parts list

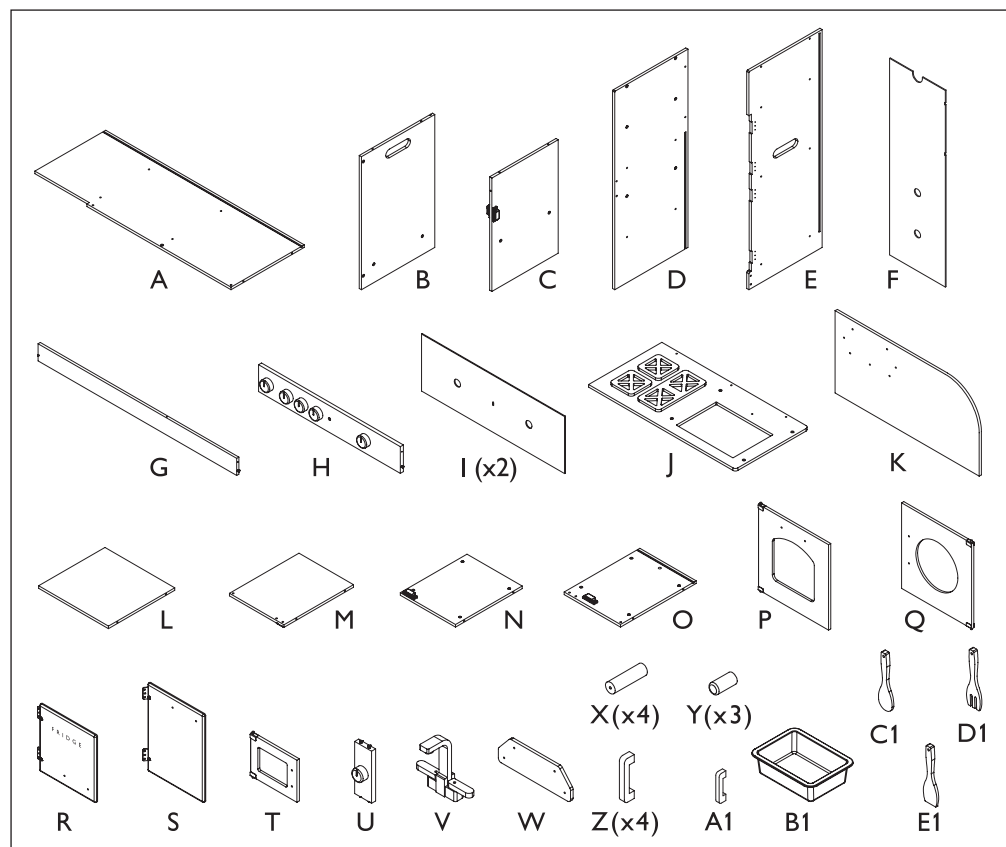

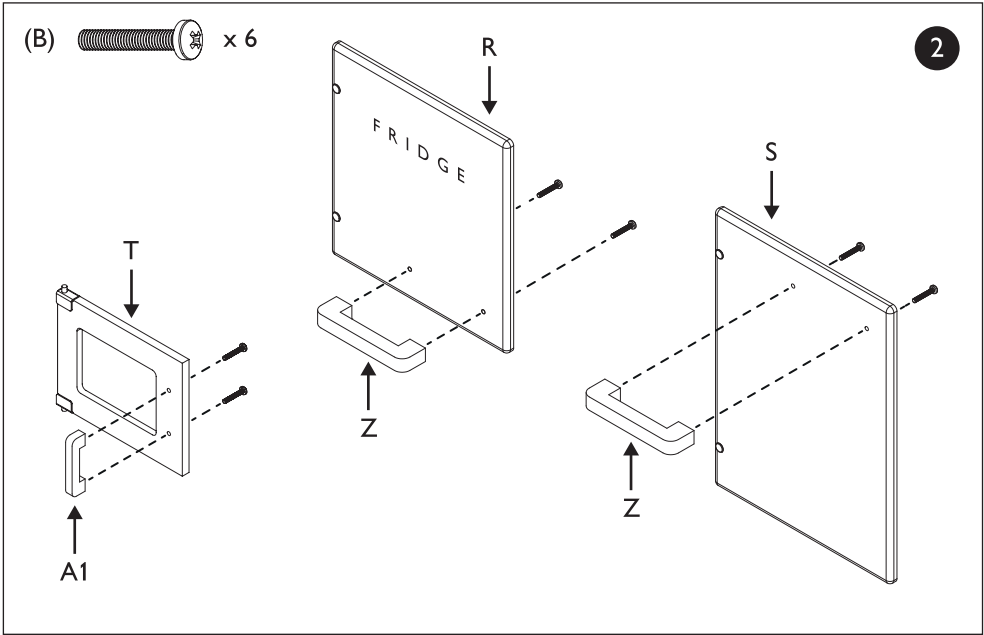
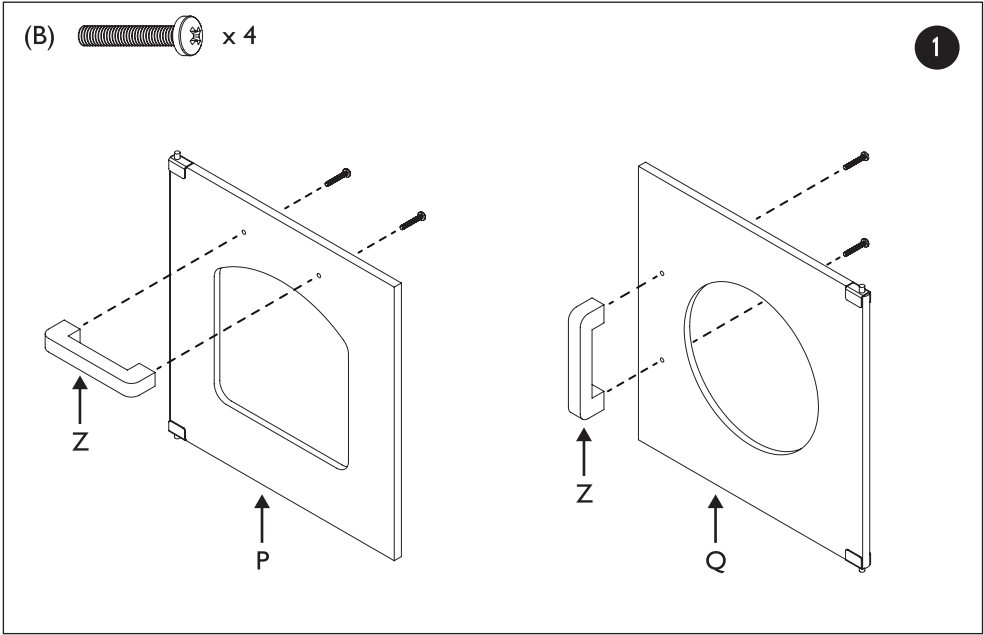

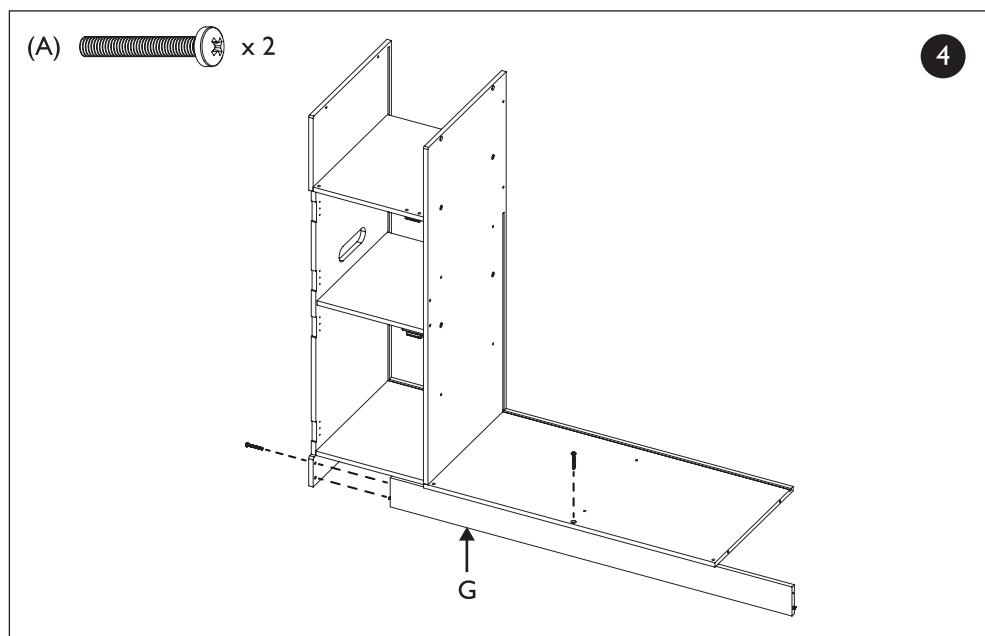
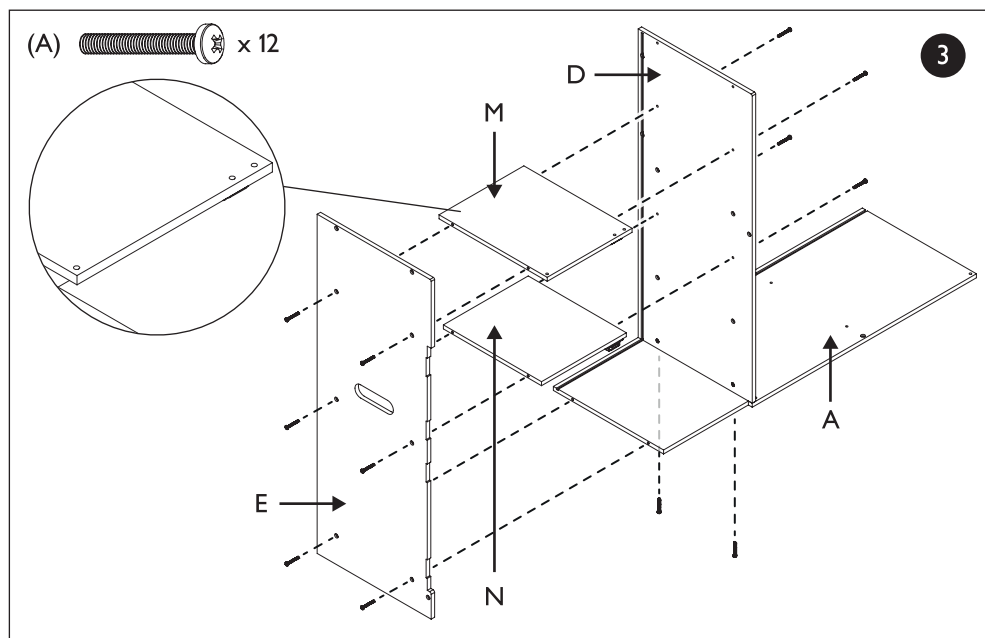

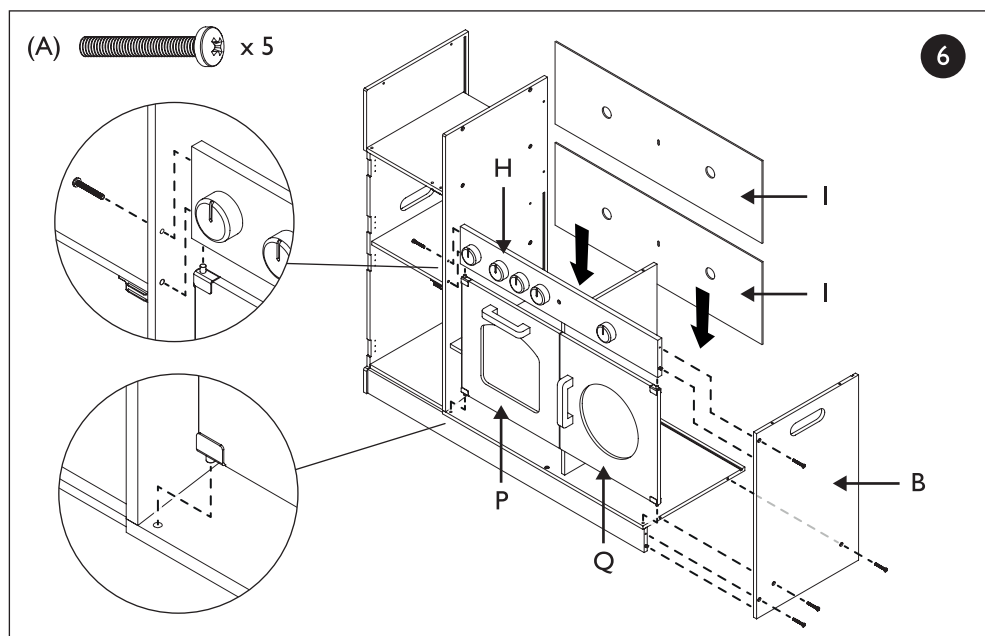
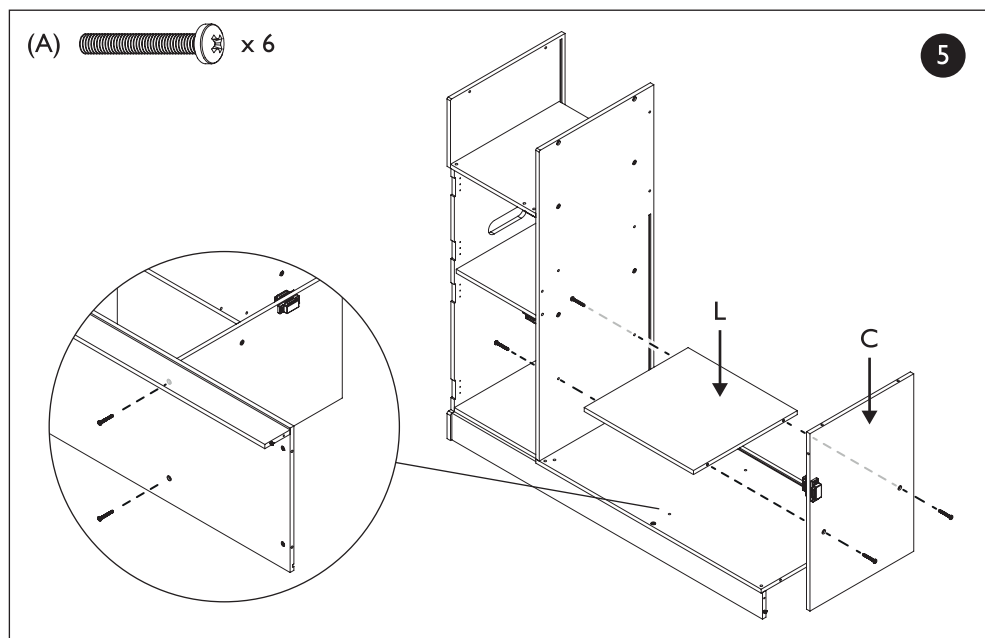

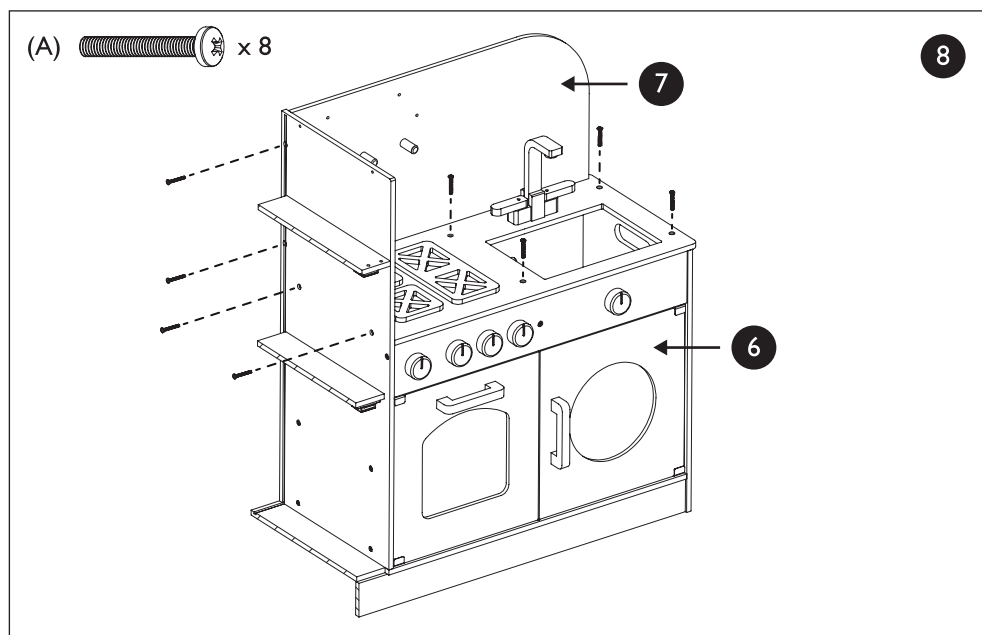
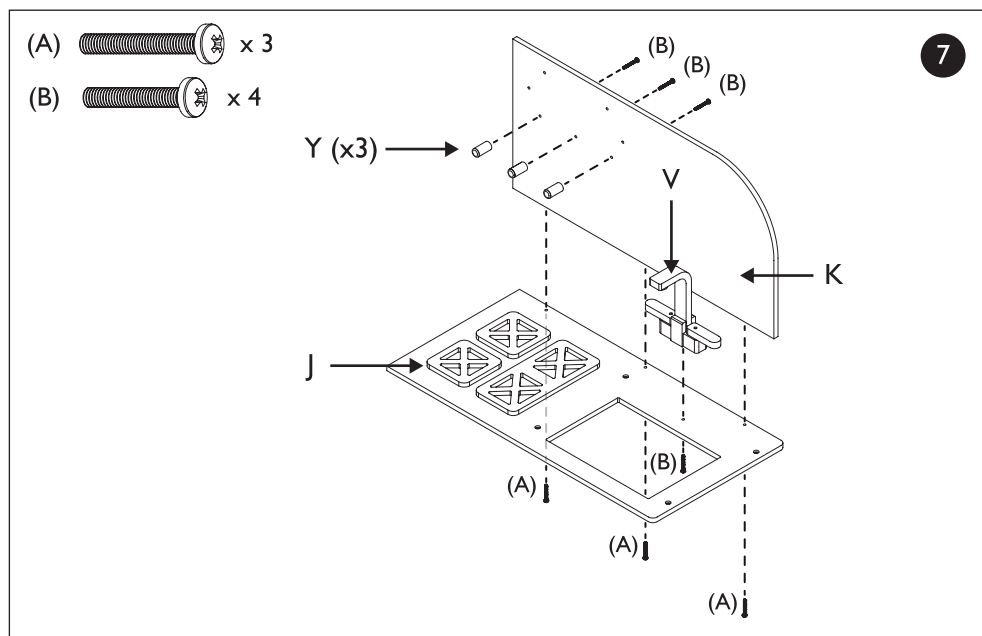

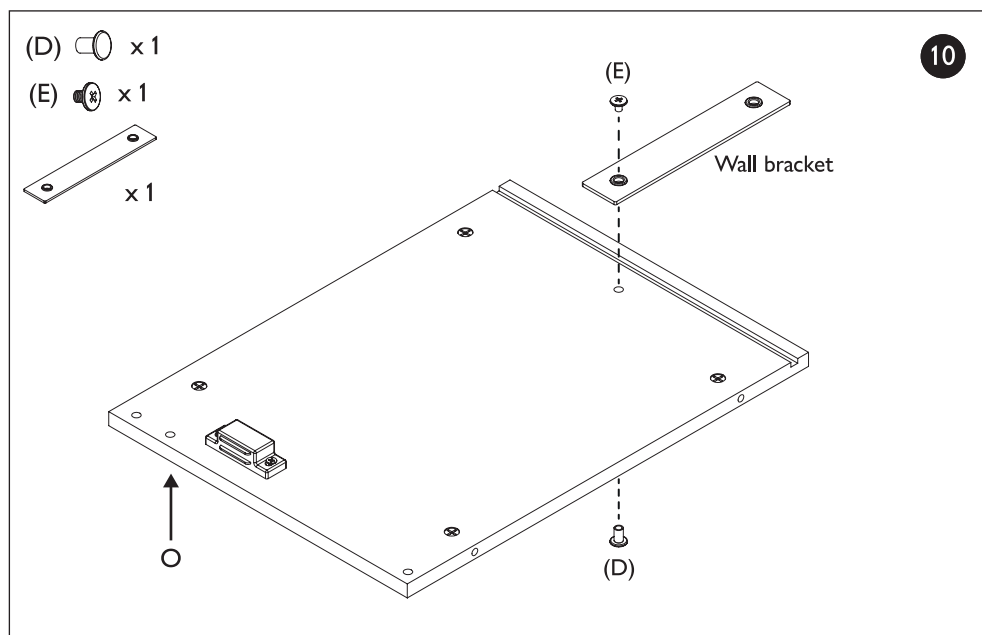
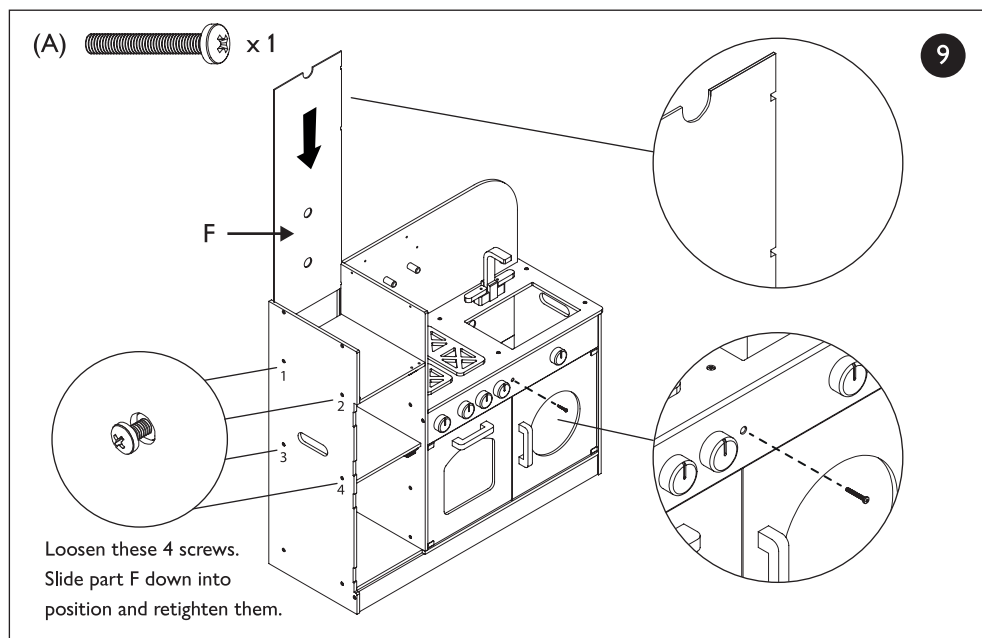





13

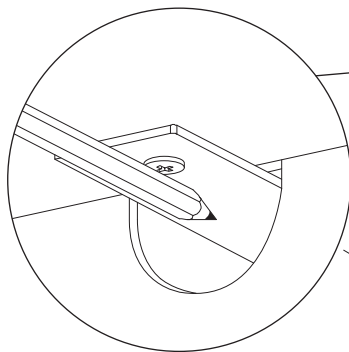

### Wall attachment

Position the unit against the wall and use the slot as shown to mark the location to drill.

Refer to wall mounting and fixing warnings on page 10 and 11 before drilling the wall.

Wall fixings not provided.

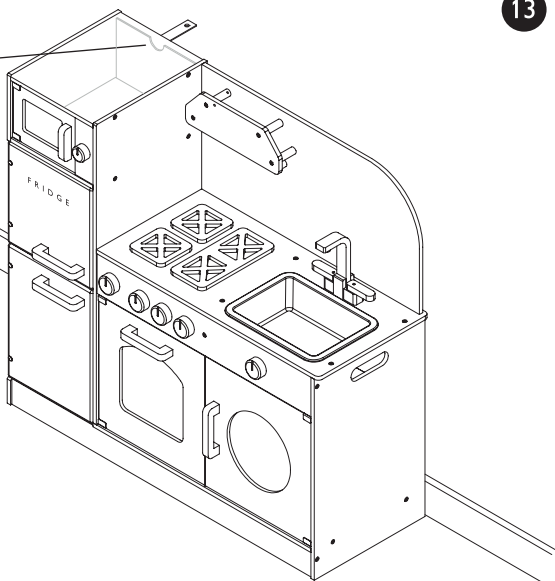

14

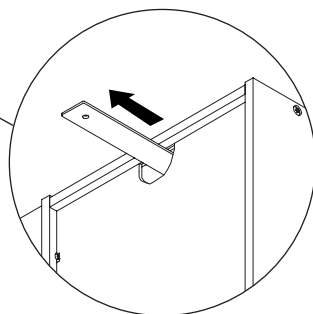
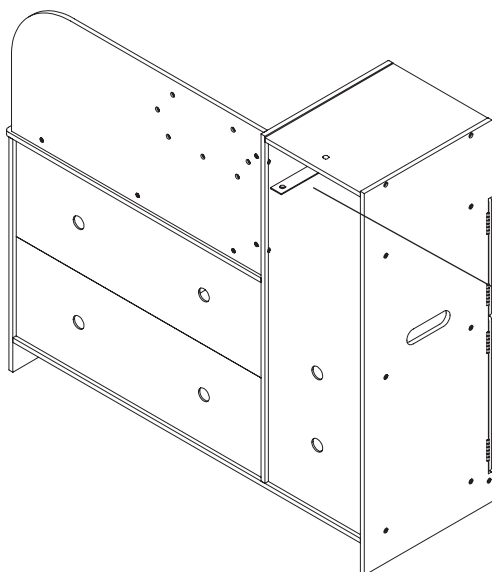

Ensure the strap is threaded through the gap at the back of the panel.

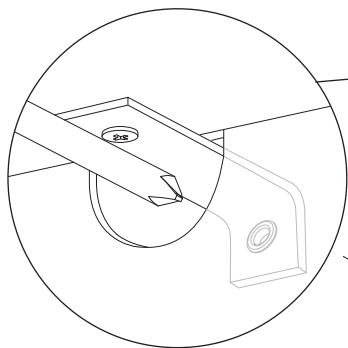

### Wall attachment

Using the access slot at the back of the panel, secure the strap to the wall using a screwdriver.

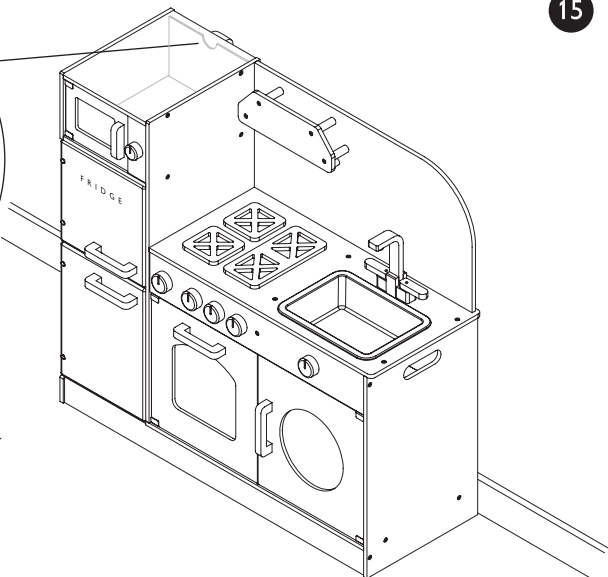

### Important safety information

**⚠ Warning:** In order to prevent overturning, this product must be used with the wall attachment device provided.

Serious or fatal crushing injuries can occur from furniture tipping over. To help prevent topple over, please observe the following:

1. Use the wall attachment device provided
2. Never allow children to climb or hang on drawers, doors or shelves.
3. Place heaviest items in the lower drawers or shelves.
4. Never open more than one drawer at a time.

An attachment device is provided with your product; however, you will need to source suitable fixings for your wall type. If in doubt, please consult a qualified tradesperson.

Always ensure the wall to be drilled is free from hidden electrical wires, water and gas pipes.

## Wall mounting and fixings

### ⚠ Warning

In order to prevent overturning this product must be used with the wall attachment device provided.

Wall fixing screws are not included, since different wall materials require different types of screws/ fixings. Please ensure you use the correct screws/ fixings for your type of walls and seek professional advice if you are not sure.

## Assembly

Installation shall be carried out exactly according to the instructions provided - otherwise a safety risk can occur if incorrectly installed. Failure of the product due to incorrect fixings is the responsibility of the installer.

**Important:** When drilling into the walls always check that there are no hidden wires or pipes etc.

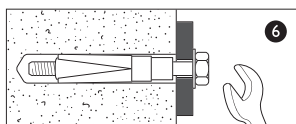
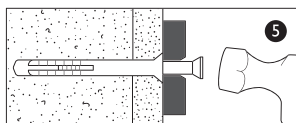
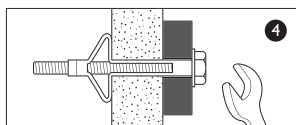
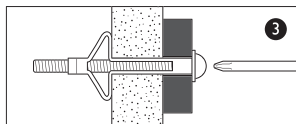
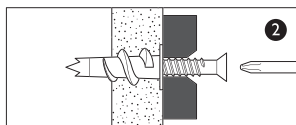
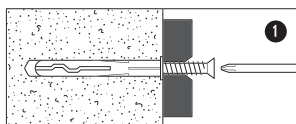

### Types of walls

You can use one of the following types of wall plug if your walls are made of brick, breezeblock, concrete, stone or wood.

#### 1. General Purpose wall plug

Generally aerated blocks should not be used to support heavy loads, use a specialist fitting in this case. For light loads, general - purpose wall plugs can be used.

#### 2. Plasterboard wall plug

For use when attaching light loads on to plasterboard partitions.

#### 3. Cavity Fixing wall plug

For use with plasterboard partitions or hollow wooden doors.

#### 4. Cavity Fixing- Heavy Duty wall plug

For use when fitting or supporting heavy loads such as shelving, wall cabinets and coat racks.

#### 5. Hammer Fixing wall plug

For use with walls stuck with plasterboard. The hammer fixing allows it to be fixed to the wall rather than the plasterboard. Always check the fixing is secure to the retaining wall.

#### 6. Shield Anchor wall plug - Heavy loads

For use with heavier loads such as 1V and Hi-Fi speakers and satellite dishes etc.

### ⚠ Care and maintenance

**Safety:** Periodically check all fittings and wall fixings to ensure they have not come loose and retighten as necessary.

---

**Warnings!**

Not suitable for children under 3 years.  
Small parts - Choking hazard.

Adult supervision is required at all times.

The unassembled product contains small parts and sharp edges that are not suitable for children to access.

Care should be taken in unpacking and assembly.

Fittings may loosen with use over time. Regularly check and tighten loose fittings to prevent children from removing them and to preserve the strength of the product. Do not over-tighten them.

Remove all packaging / tags before giving to a child.

---

Please retain this information leaflet for future reference.

John Lewis Plc  
171 Victoria Street  
London SW1E 5NN  
[johnlewis.com](http://johnlewis.com)