

The background of the top half of the page is white, overlaid with a large, bold 'X' shape. The 'X' is formed by two intersecting yellow rectangles. The text 'JOHN LEWIS & PARTNERS' is centered over this graphic.

JOHN LEWIS & PARTNERS

Wooden modern kitchen

Thank you for purchasing this toy.
Please read the instructions and warnings
carefully before use.

Assembly instructions

Adult assembly of this product is required.
Cross head screwdriver required for assembly.

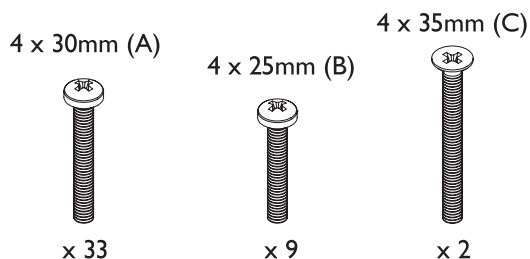

Parts list

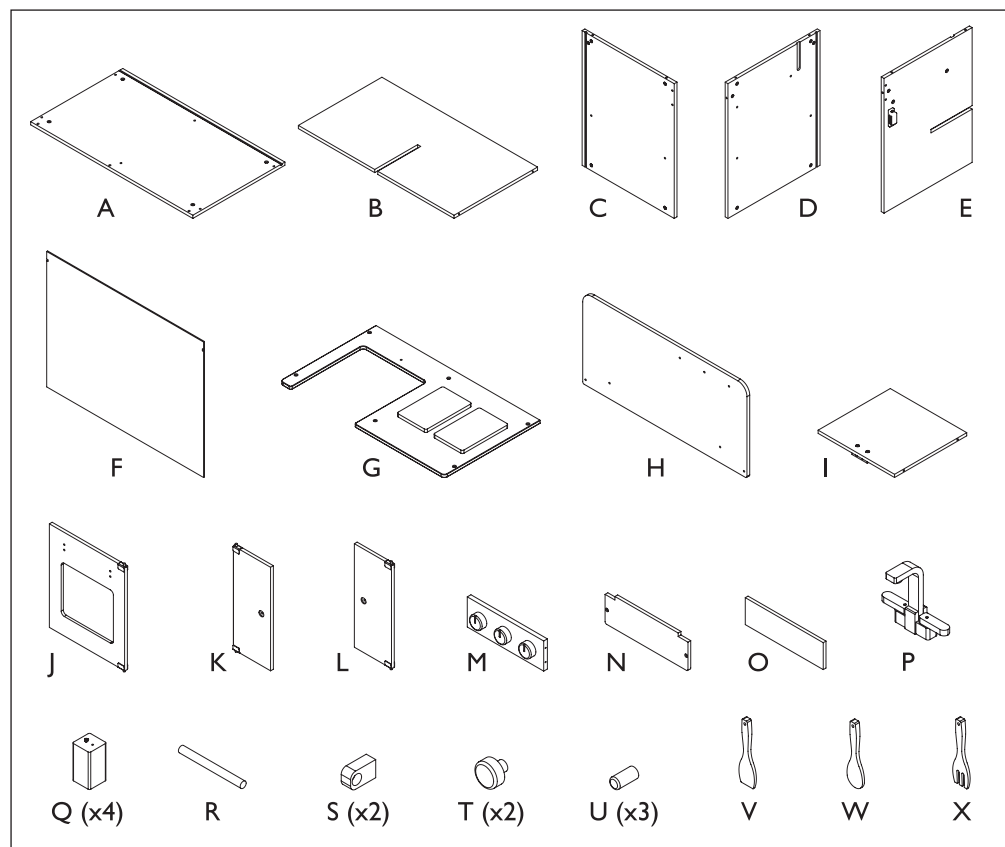

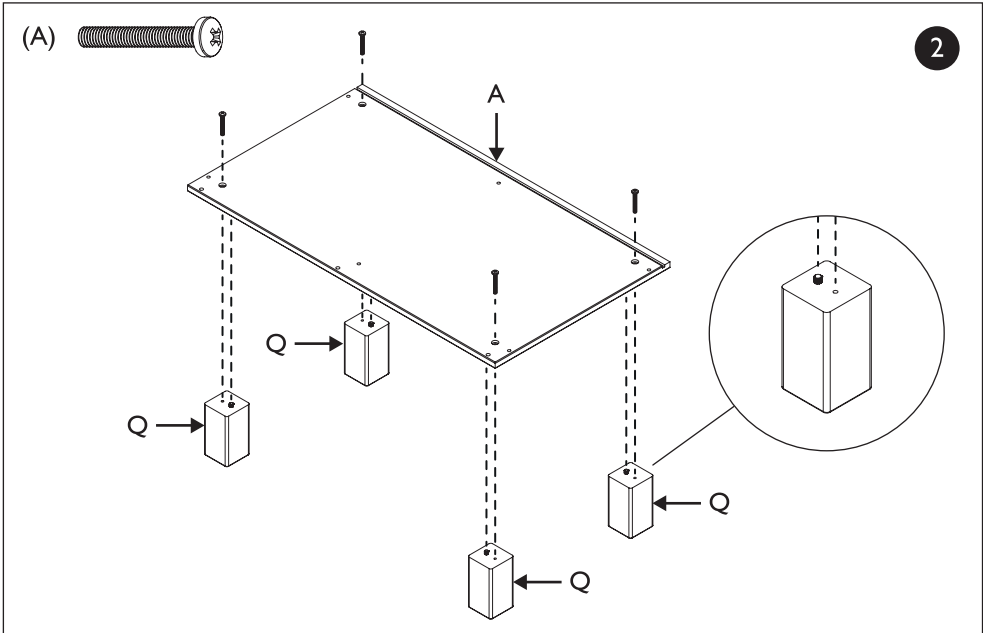
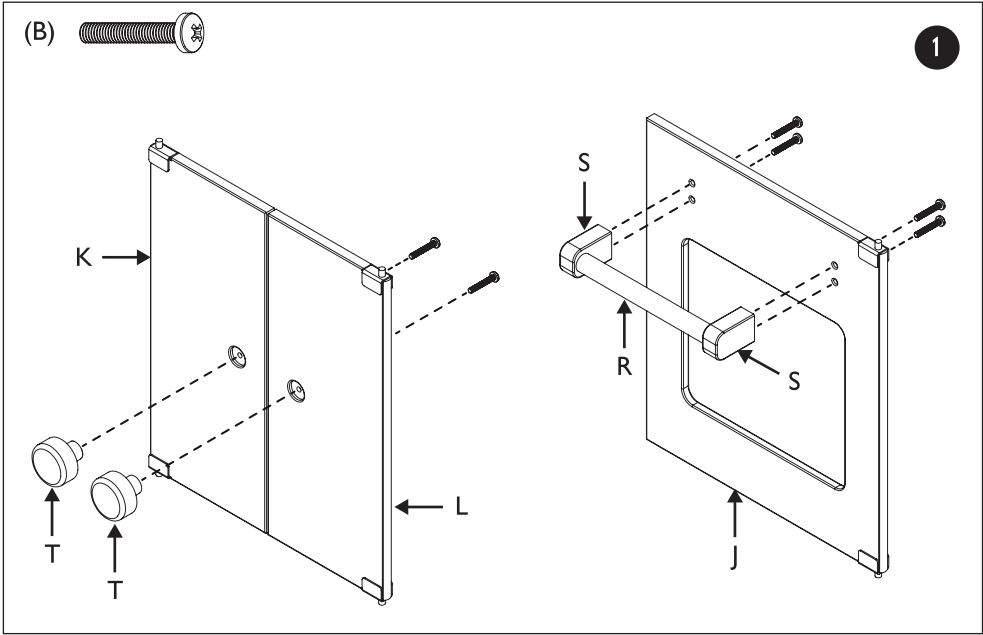

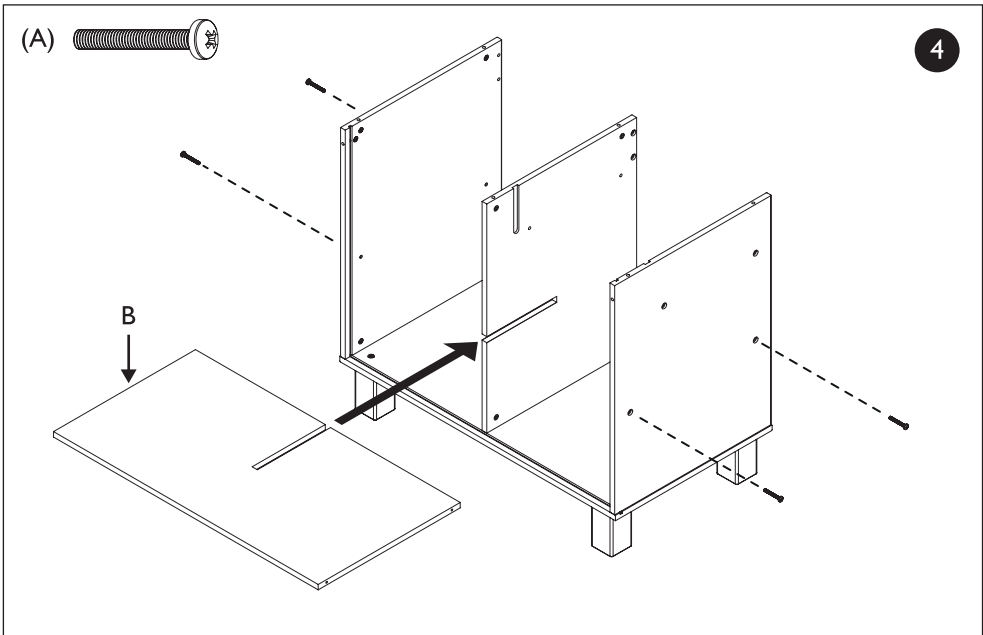
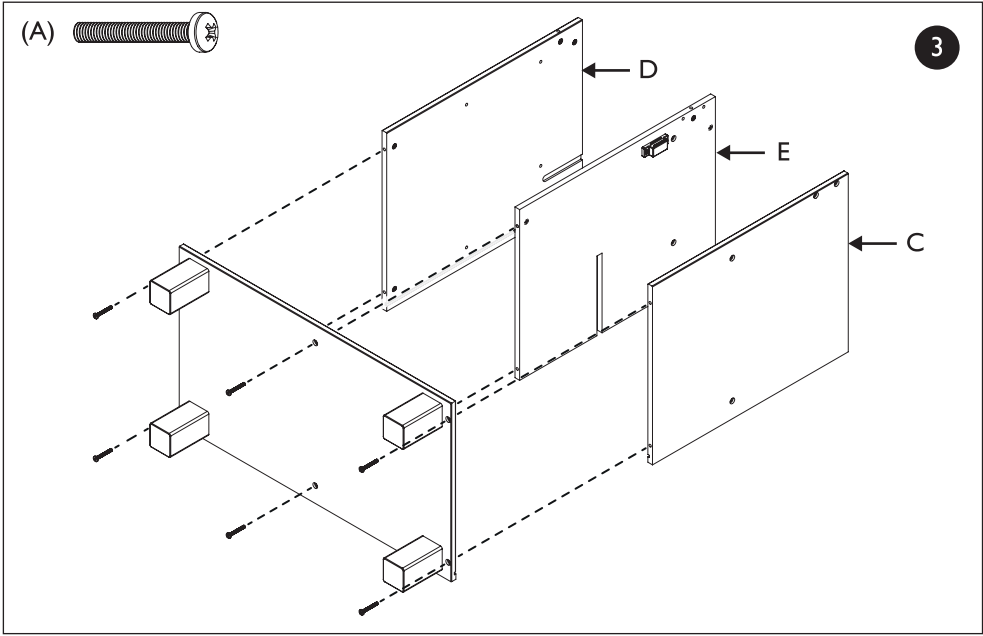

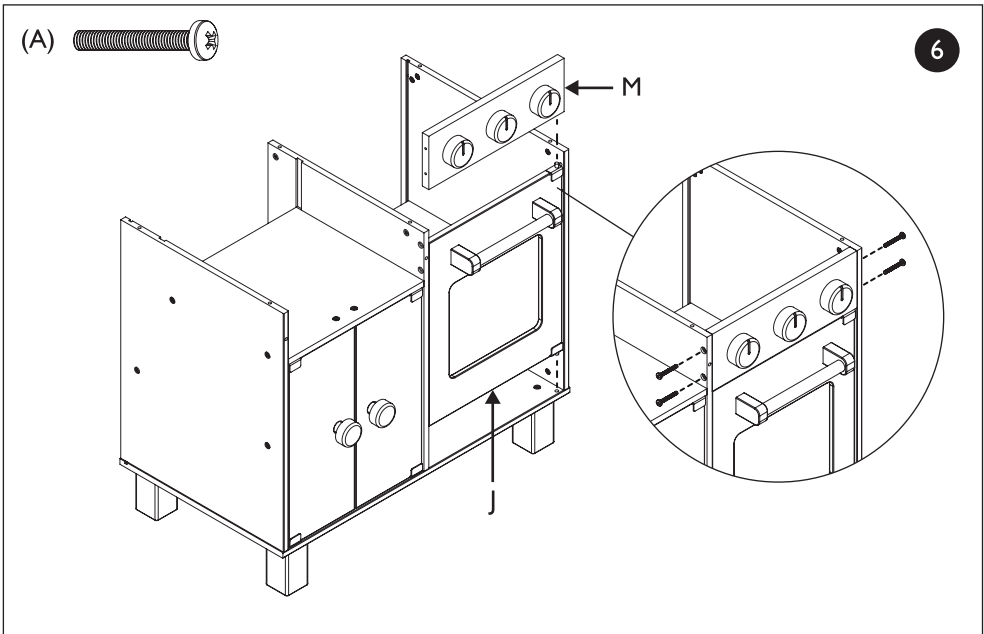
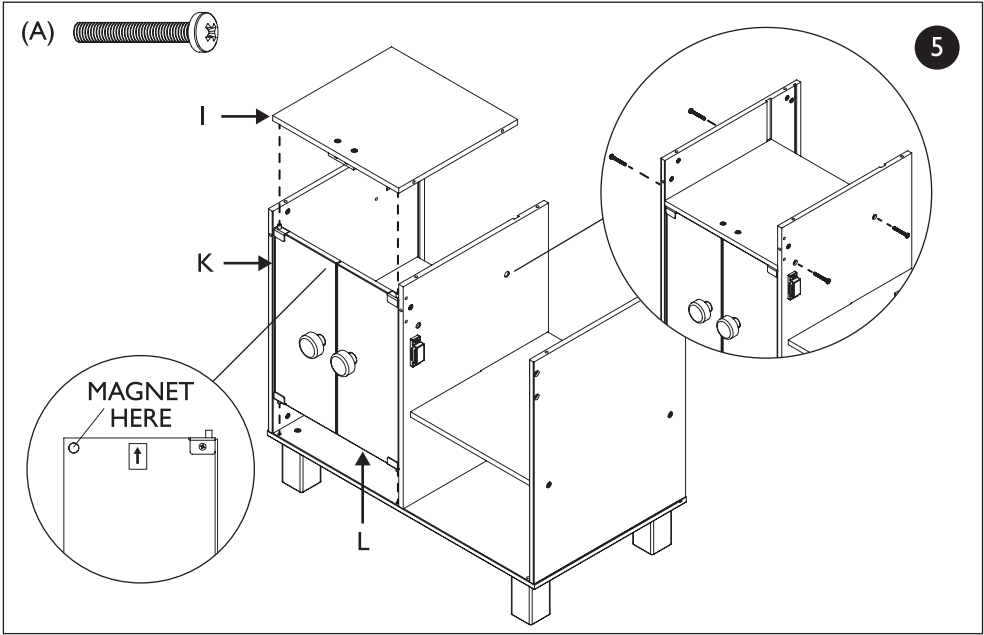

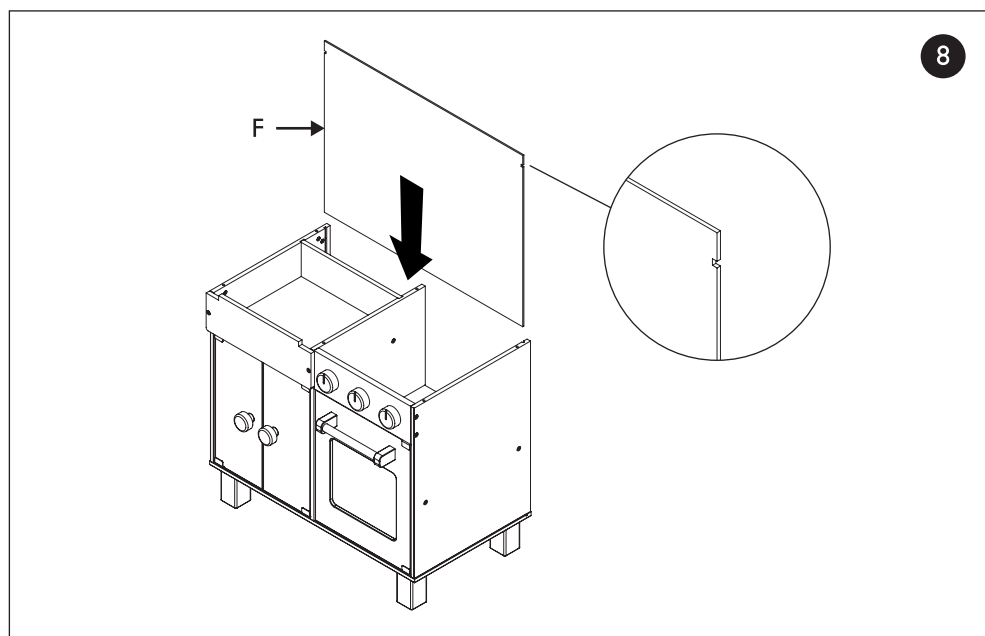
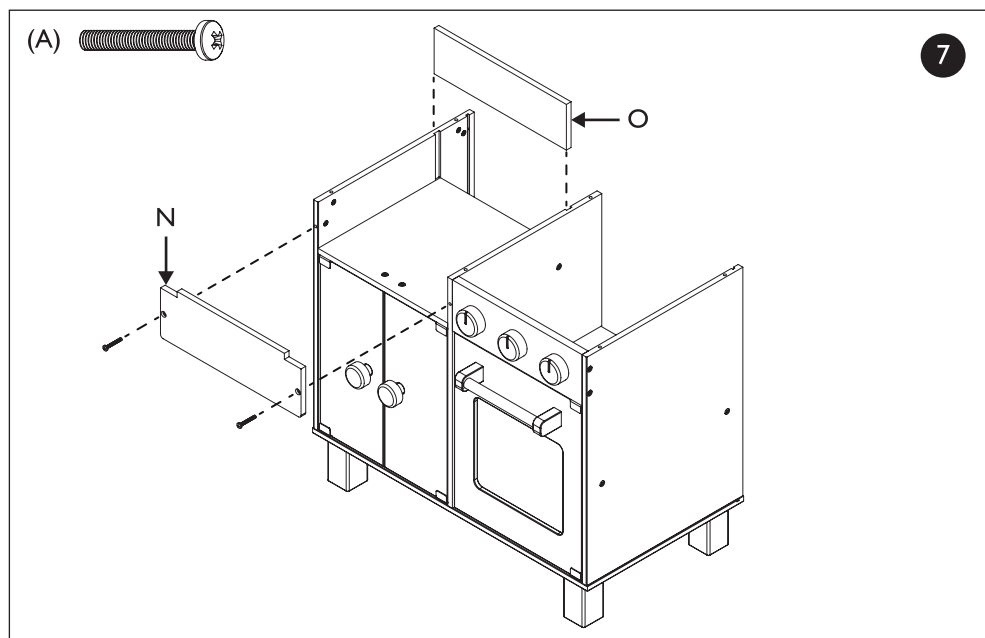

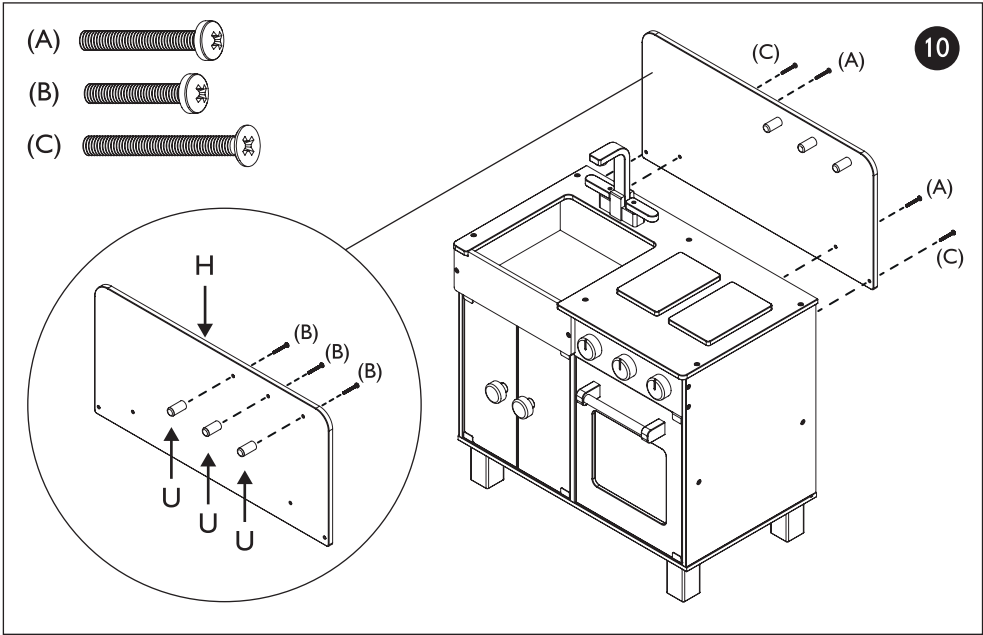
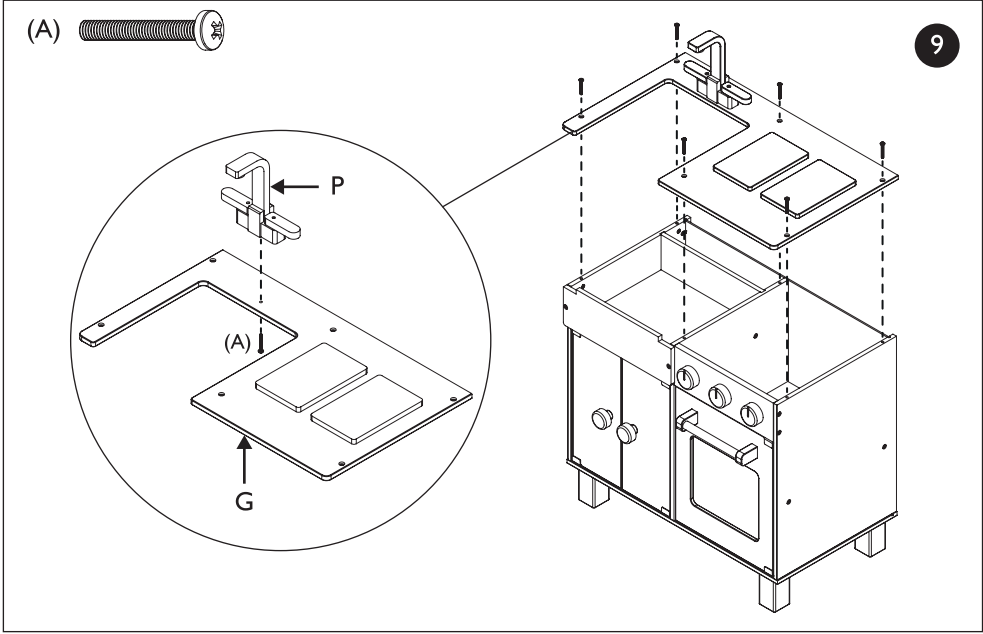

Warnings!

Not suitable for children under 3 years.
Small parts - Choking hazard.

Adult supervision is required at all times.

The unassembled product contains small parts and sharp edges that are not suitable for children to access.

Care should be taken in unpacking and assembly.

Fittings may loosen with use over time. Regularly check and tighten loose fittings to prevent children from removing them and to preserve the strength of the product. Do not over-tighten them.

Remove all packaging / tags before giving to a child.

Please retain this information leaflet for future reference.

John Lewis Plc
171 Victoria Street
London SW1E 5NN
johnlewis.com