

SINAMAY PENDANT USER GUIDE

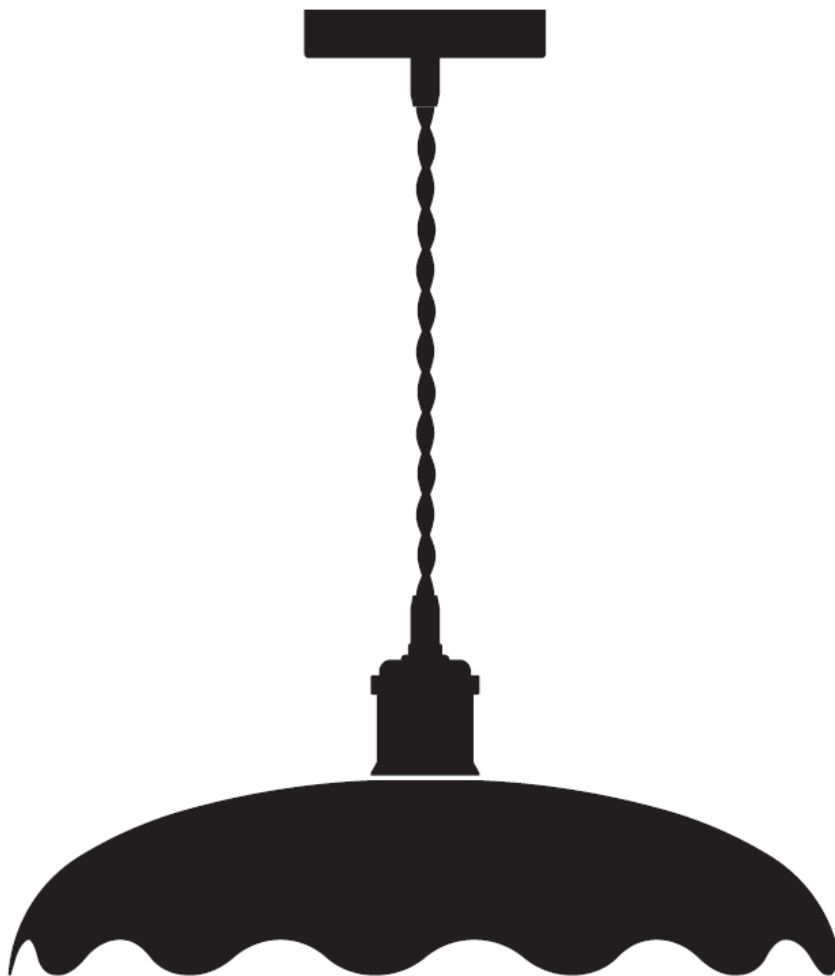

Product code
701 41903

Getting started

Thank you for purchasing this Sinamay pendant shade. Please read the instructions carefully before use to ensure safe and satisfactory operation of this product.

Warnings

For your safety, this product must be installed in accordance with local Building Regulations.

If in any doubt, or where required by the law, consult a competent person who is registered with an electrical self-certification scheme. Further information is available online or phone your Local Authority.

To prevent electric shock, switch off the mains supply before installing or maintaining this product. Ensure other persons cannot restore the electricity supply without your knowledge.

Always use the correct bulb type with the correct wattage as indicated in the specification table. This product is Class I $\text{I}=\frac{\text{—}}{\text{—}}$ and should be fitted to a lighting Supply protected by a 5 amp fuse or equivalent circuit breaker.

When changing the bulb, always switch off at the mains and allow the old bulb to cool down before handling. Dispose of used bulbs carefully.

Caution! The bulb and surrounding parts can become hot during use.

For indoor use only.

Parts List

Ref	Description	Qty
A	Mounting bracket	1
B	Screw fixings	2
C	Light fitting	1
D	Metal shade ring	1
E	Shade	1

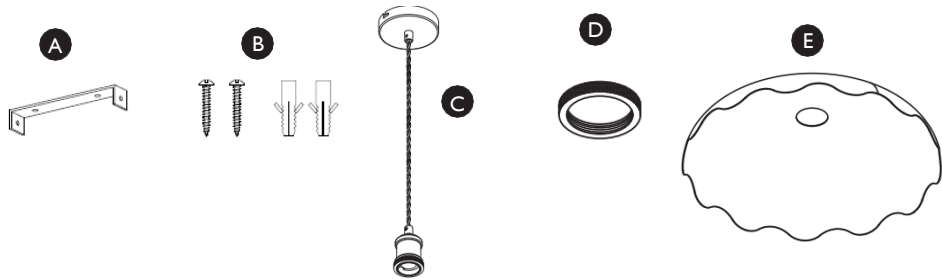

Product assembly

Height Adjustment: This fitting is height adjustable at point of installation only. No attempt must be made to adjust the height once it has been attached to the ceiling. If adjustment is required at a later date the fitting must be isolated from the mains and removed from the ceiling first. Lay the fitting on a clear covered surface. Using a suitably sized flat bladed screwdriver loosen the plastic screw clamp under the ceiling cup, also undo the screws or clamp located in the ceiling cup. Carefully pull the cable through the ceiling cup to the desired height and then retighten all screws to ensure that clamps are fully secured.

Step 1

Remove mounting bracket (A) from fitting by removing the retaining screws and any washers, retain for later. Using the mounting bracket as a template, mark and then drill the fixing holes in the mounting surface. (ensure the screws (B) are firmly fixed into a solid or other suitable mounting and not just the plasterboard) Take care not to damage wiring.

Attach mounting bracket to the mounting surface using suitable fixings. Do not attach fitting to mounting bracket at this stage. Make sure no wires are trapped in the process.

Step 2

Ensuring the power has been isolated, feed the household supply cable through the black rubber sleeve of the terminal block and connect the electrical supply wires to the connector blocks corresponding terminals. Support the fitting weight and Make electrical connections as follows:

- Connect supply live to fitting live (marked "L") on the terminal block.
- Connect supply neutral to fitting neutral (marked "N") on the terminal block.
- Connect the supply earth to the earth (marked " \equiv ") on the terminal block.

Please note that residential wiring can vary, if you are unsure about the correct polarity please consult a qualified electrician. Ensure electrical connections are tight and no loose strands of wire protrude from the terminal block then close connector block cover by snapping back together. Excess cable must be carefully located inside the ceiling cup or within the ceiling cavity itself.

Step 3

Carefully offer fitting (C) over mounting bracket then secure in place with the screws and any washers removed earlier. Take care not to damage the wiring.

Step 4

Remove the shade ring already attached to the lamp holder section (D) and place the shade (E) over the lamp holder section. Refit the shade ring to secure in place.

Fit the bulb: type and wattage as indicated on the fitting.

The wattage indicated must not be exceeded.

Once installation is complete, the house electricity may be restored at the fuse box.

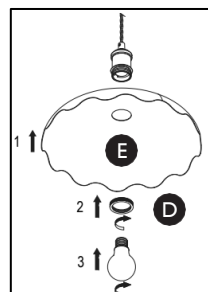
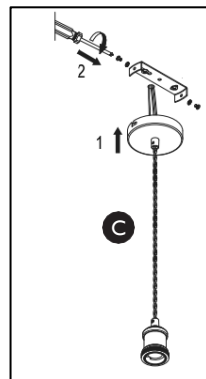
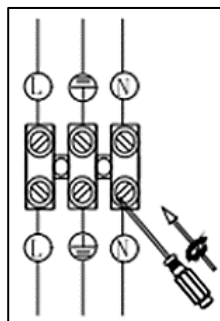
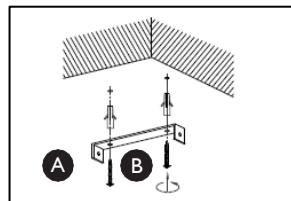

Product information

- Indoor use only
 - Dimmable
 - Replacement bulbs should be the same type and rating, available from John Lewis
 - Partners or other established brands
- Clean the fitting with a soft dry cloth

Aftercare and troubleshooting

If you experience any unresolvable technical issues with the product, contact your nearest John Lewis & Partners shop or John Lewis & Partner Technical Support on 03301 230106.

Why is the light not working when switched on?

Check your power supply is switched on

Turn off light and check that the bulb is inserted correctly

Check the bulb is still in working order.

Specification

Max. power: 28W or 5-7W LED (400-700 lumen) Voltage: 220–240V, 50Hz

IP rating: 20

Weight: 1.kg

5-year guarantee

At John Lewis & Partners we test every light to high quality standards so we are able to offer you a 5 year guarantee.

Recycling

This symbol  indicates that this product should not be treated as normal household waste and it should be recycled. John Lewis & Partners do not operate instore take back, but as members of the Distributor Take Back scheme have funded the development and upgrade of recycling facilities across the UK. Please take it to your nearest collection facility or for further details contact your local council or visit www.recycle-more.co.uk.

IL4387 Issue 1 05/21

John Lewis Plc
171 Victoria Street
London SW1E 5NN
johnlewis.com

Made in China

**UK
CA**

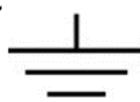

Please retain these instructions for future reference