

Liv Clothes Rail

Stock number: 413 92421

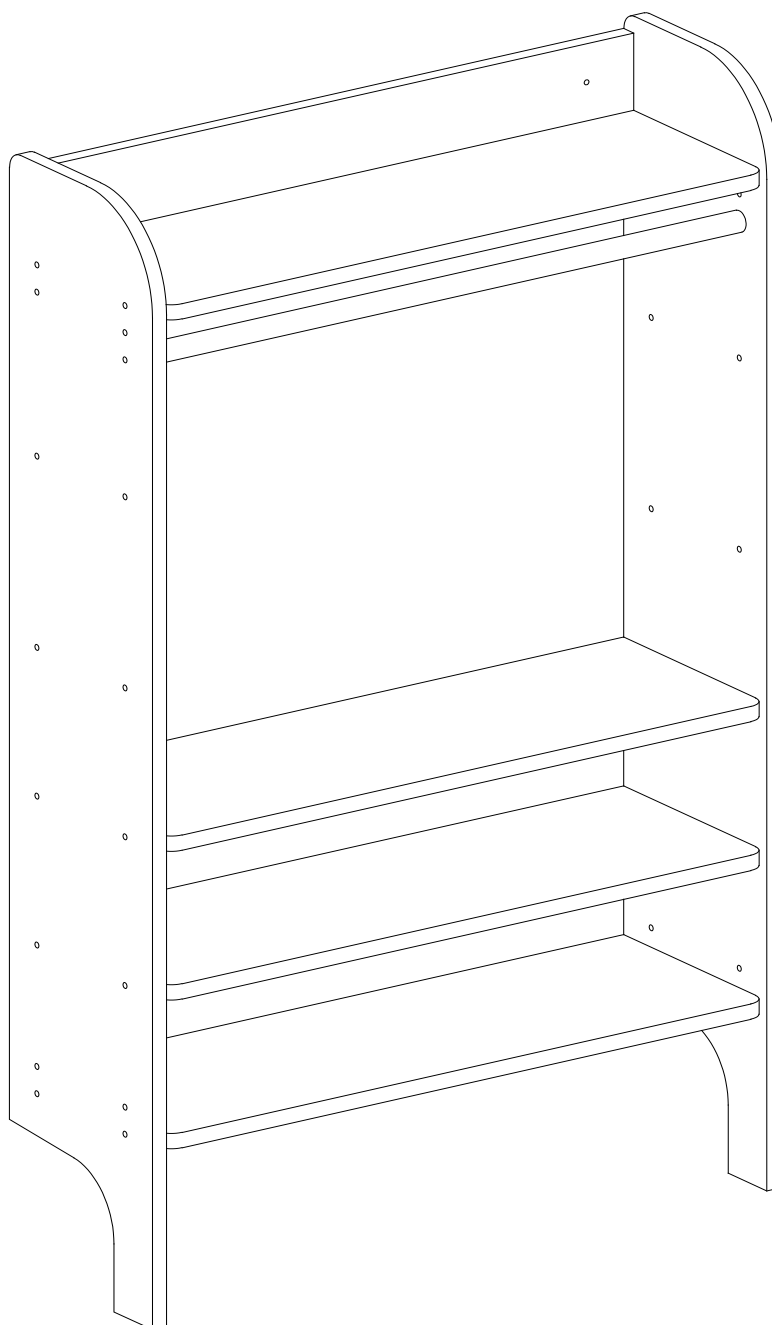

H131 W80 D26cm

Thank you for purchasing the Liv clothes rail. Please read the instructions and warnings carefully before use, to ensure safe and satisfactory operation of this product.

At John Lewis, we are committed to making great products possible.

From our in-house Design Team to our Buyers, we work together to bring great designs to life.

Our expert Product Technologists work collaboratively with our buyers and suppliers to assure the legality, safety and quality of the product we sell.

We are all committed to designing and developing products to the highest industry standards.

We hope you are happy with your product and welcome any feedback or comments you may have.

The John Lewis Team

Tools required

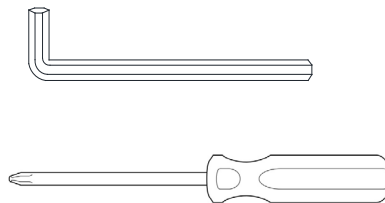

Time to assemble

1 hour

People to assemble

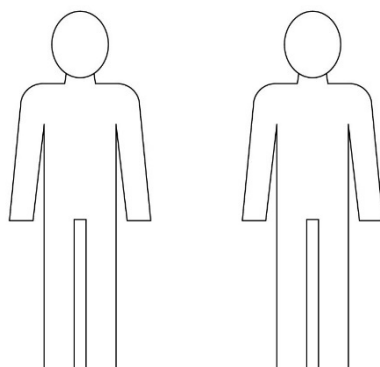

Important safety information

Warnings

- ⚠ The product should only be used on firm, level ground.
- ⚠ Keep small parts out of reach of children.
- ⚠ Ensure the product is fully assembled as illustrated before use.

Do's

- ✓ Check the pack and make sure you have all the parts listed.
- ✓ Check all screws or bolts are tightened and inspect regularly.
- ✓ Make sure the legs remain in contact with the ground at all times.

Don'ts

- ✗ Do not over tighten screws or bolts.
- ✗ Do not stand on the product.
- ✗ Do not use power tools to construct as overtightening and panel failure may occur.

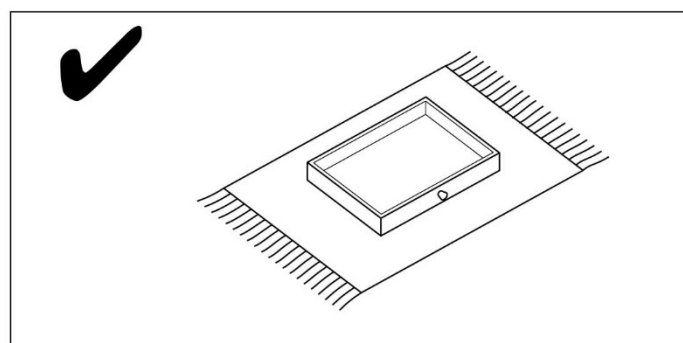
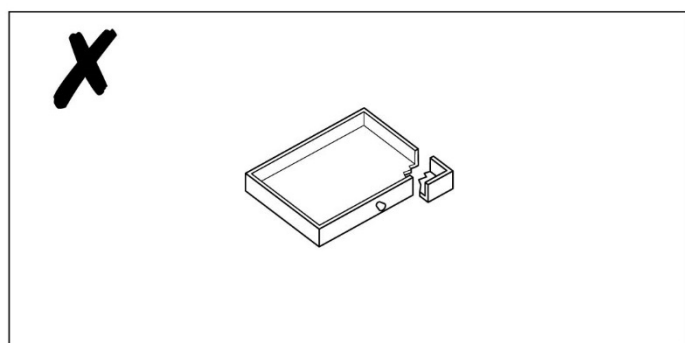
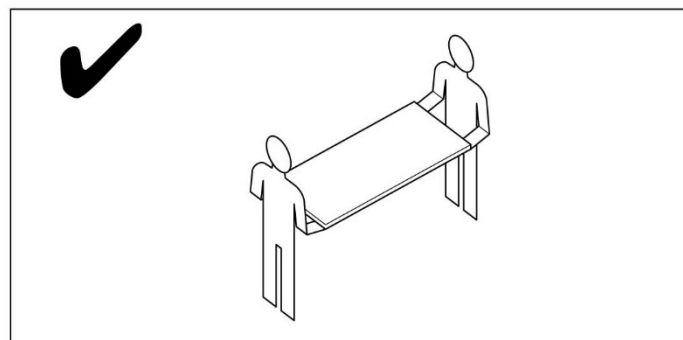
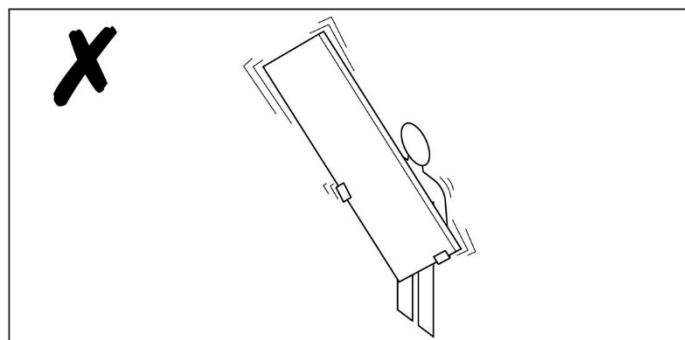
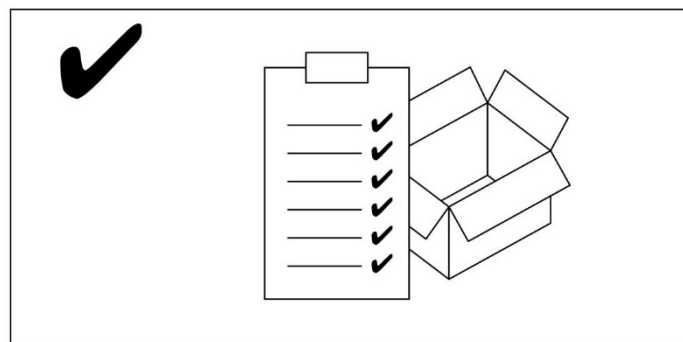
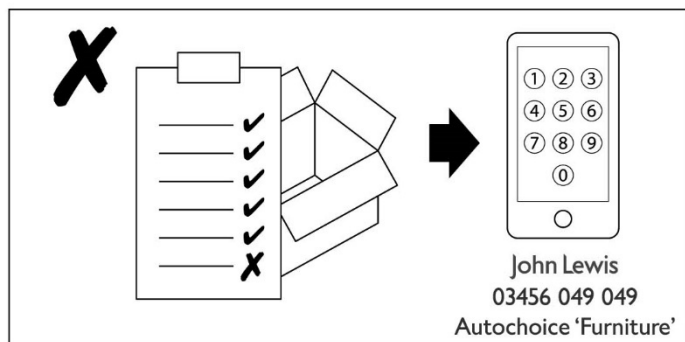

Your clothes rail

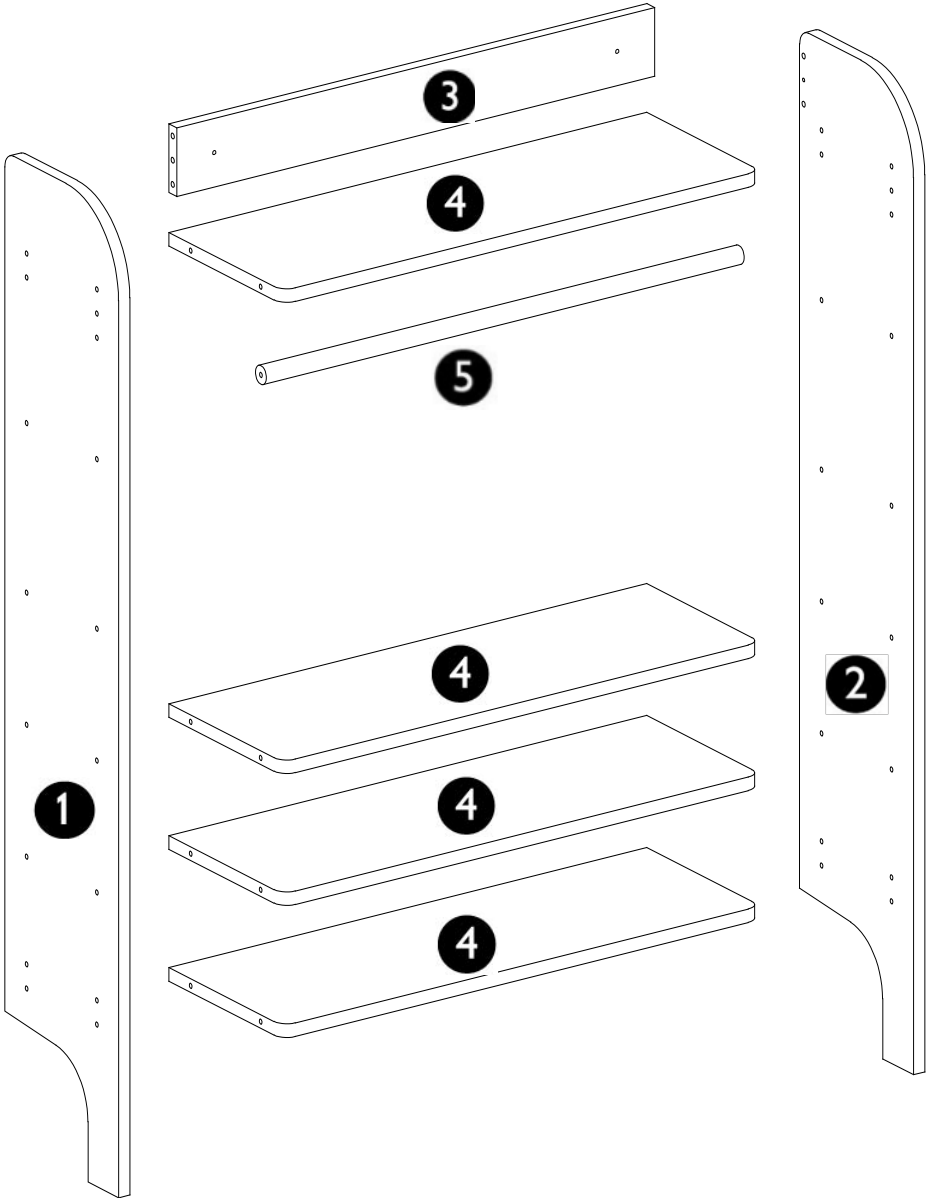

Ref	Description	Dimensions	Qty
1	Left side panel	1310x260x18mm	1
2	Right side panel	1310x260x18mm	1
3	Top back panel	764x91x18mm	1
4	Shelf	764x260x18mm	4
5	Hanging rail	Ø25x764mm	1

Fixtures and fittings

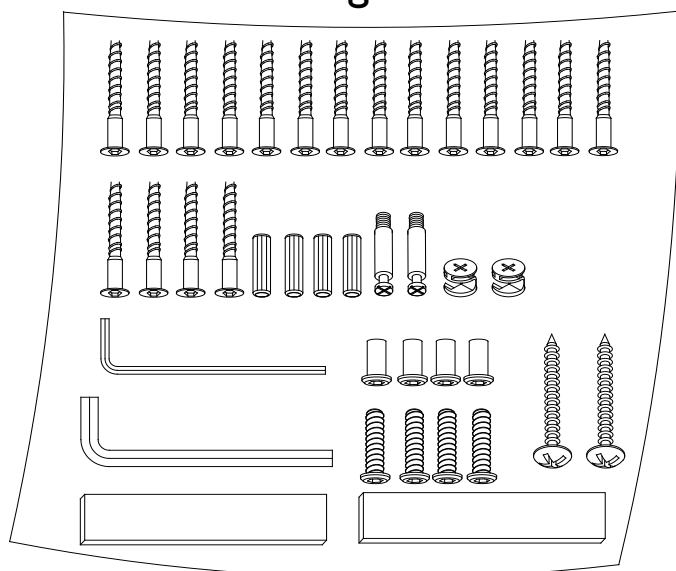

Fixtures and fittings
supplied (actual size)

Ref	Description	Dimension	Qty	mm
A	Confirmat screw	7x45mm	18	
B	Cam	15x11mm	2	
C	Cam Stud	M6x34mm	2	
D	Dowel	Ø8x30mm	4	
E	Female connector	M4x14mm	4	
F	Male connector	M4x35mm	4	
G	Felt pad	60x15x3mm	2	

Fixtures and fittings
supplied (Not actual size)

H	Large allen key	4x65mm	1	
I	Small allen key	3x45mm	1	
J	Wall fixing screw (See page 10)	Ø9.5x50mm	2	

Product assembly

Liv Clothes Rail
413 92421

Step 1

Parts, fittings and tools

1 2 C D

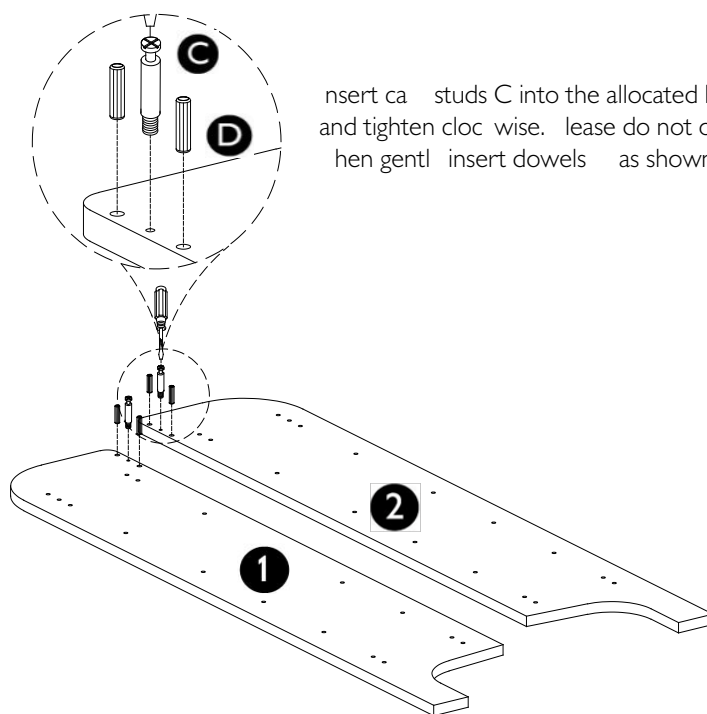

Insert cam studs C into the allocated holes in the side panels and tighten clockwise. Please do not over-tighten! Then gently insert dowels as shown.

Step 2

Parts, fittings and tools

1 2 3 4 A

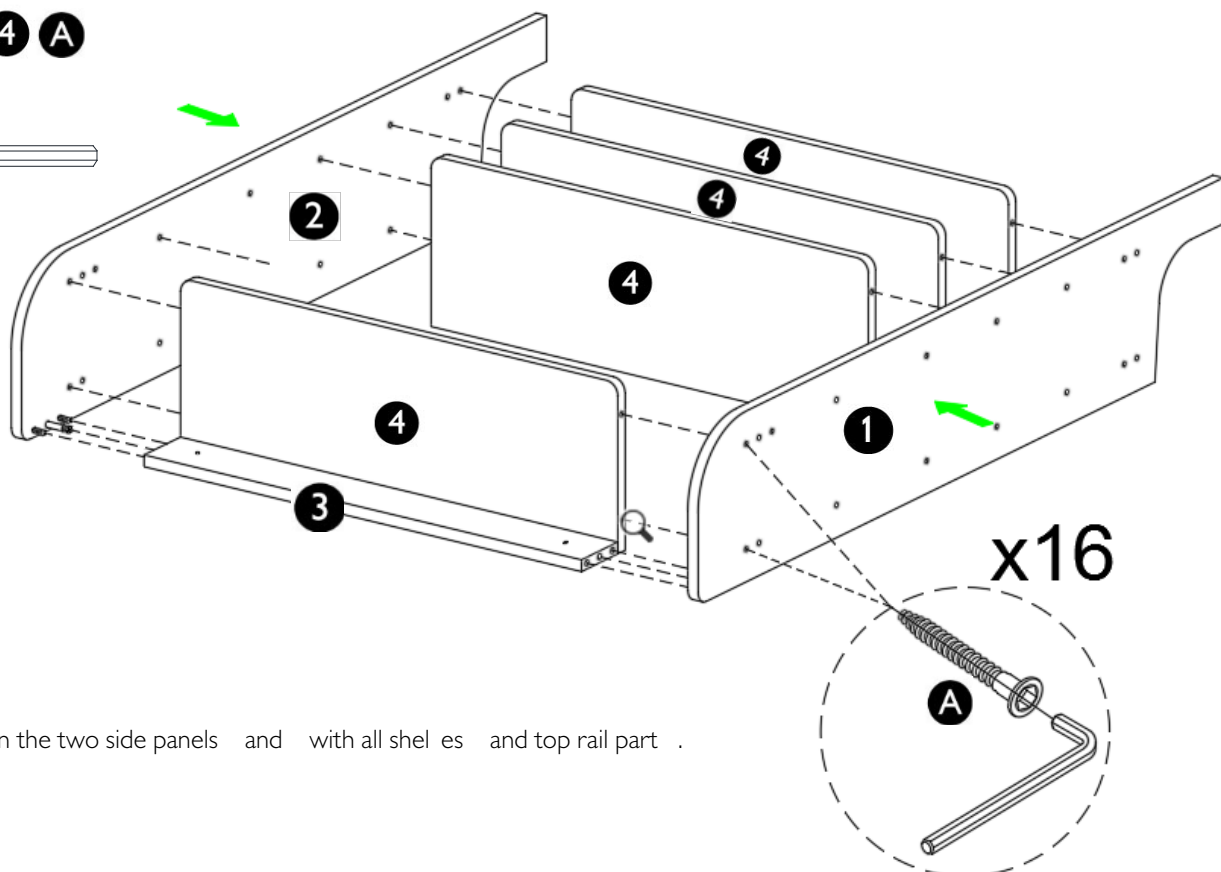

Join the two side panels and with all shelves and top rail parts.

Step 3

Parts, fitting and tools

5 A

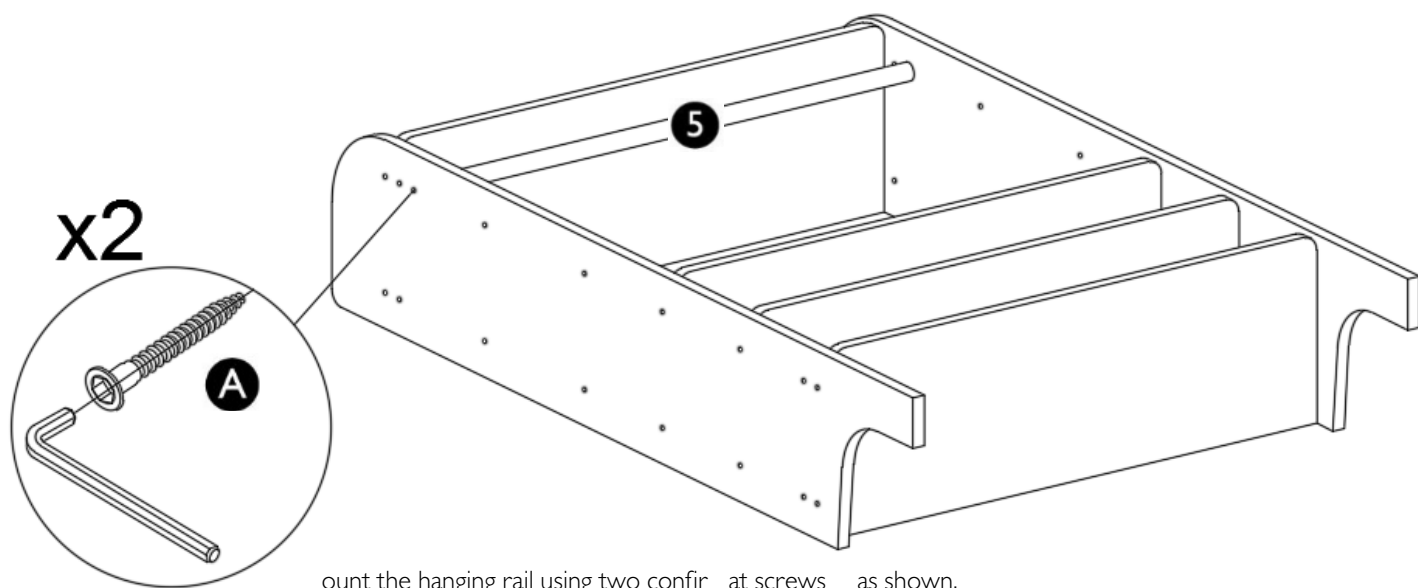

Step 4

Fittings

G

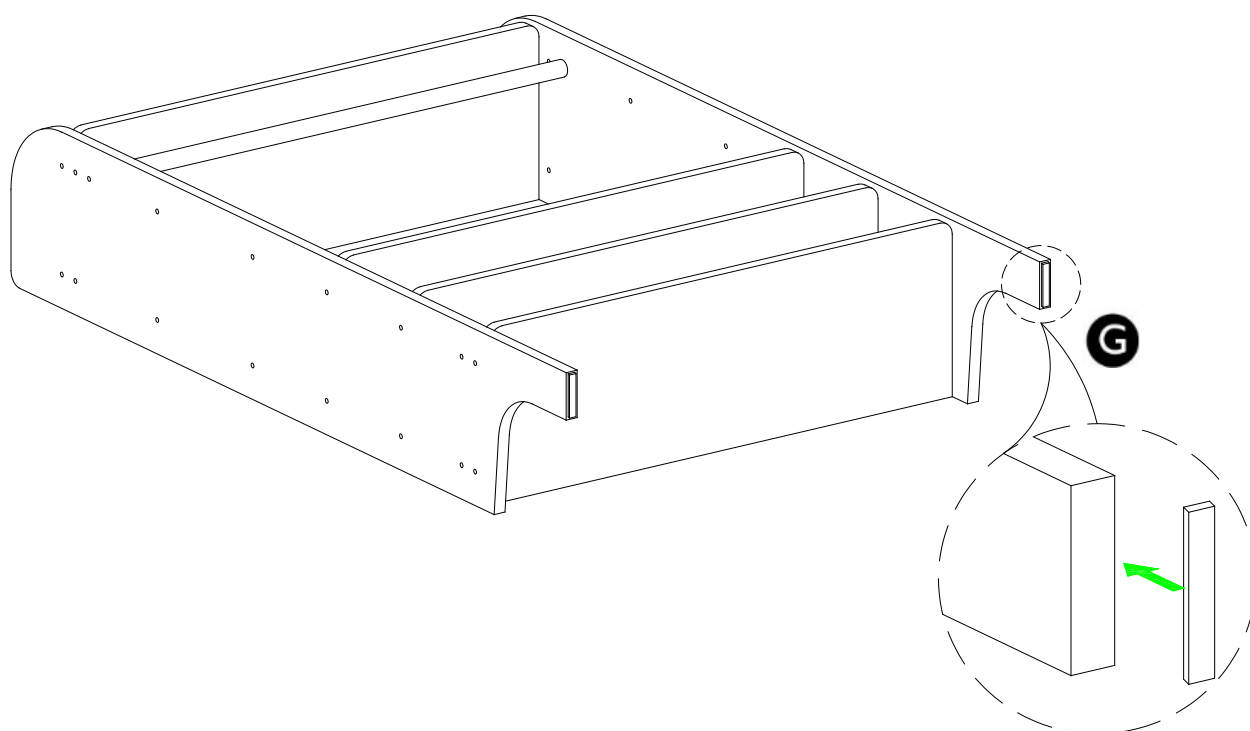

Step 5

Fittings and tools

B

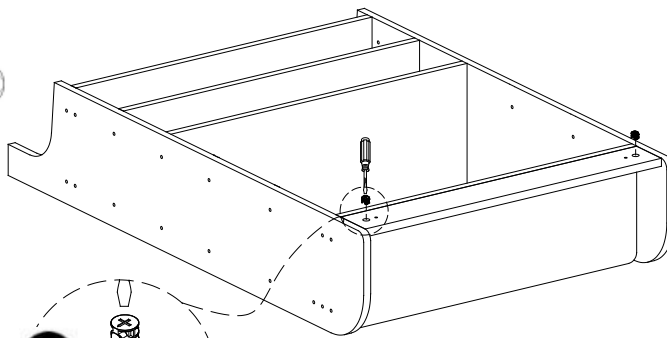

Insert caps as shown and gently tighten clockwise. Please do not over-tighten as this will damage our fittings.

Step 6 – wall fixing

This unit has been designed to be permanently fixed to the wall. Please see page 10 for guidance.

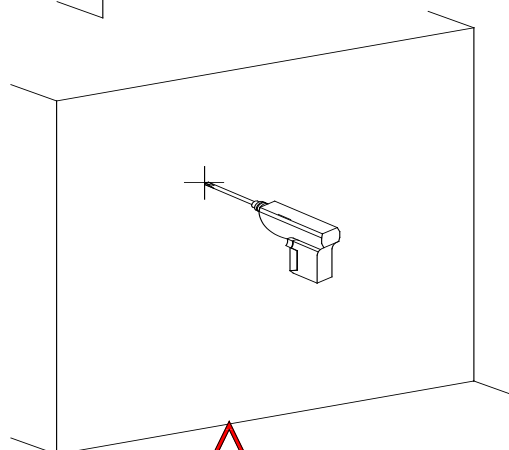
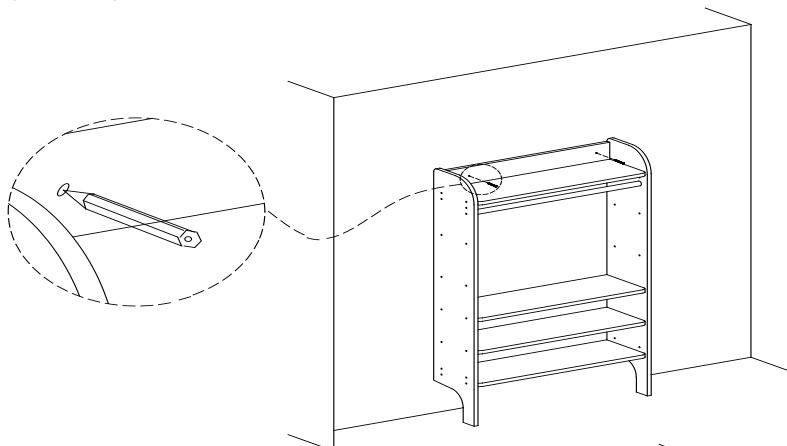

Warning

Serious or fatal injuries can occur from furniture tipping over. To prevent this furniture from tipping over it must be permanently fixed to the wall.

Step 7 – Connecting with other Liv wall units

Parts, fittings and tools

E **F**



Connectors E&F supplied with this unit can be used for connecting to other Liv units as shown.

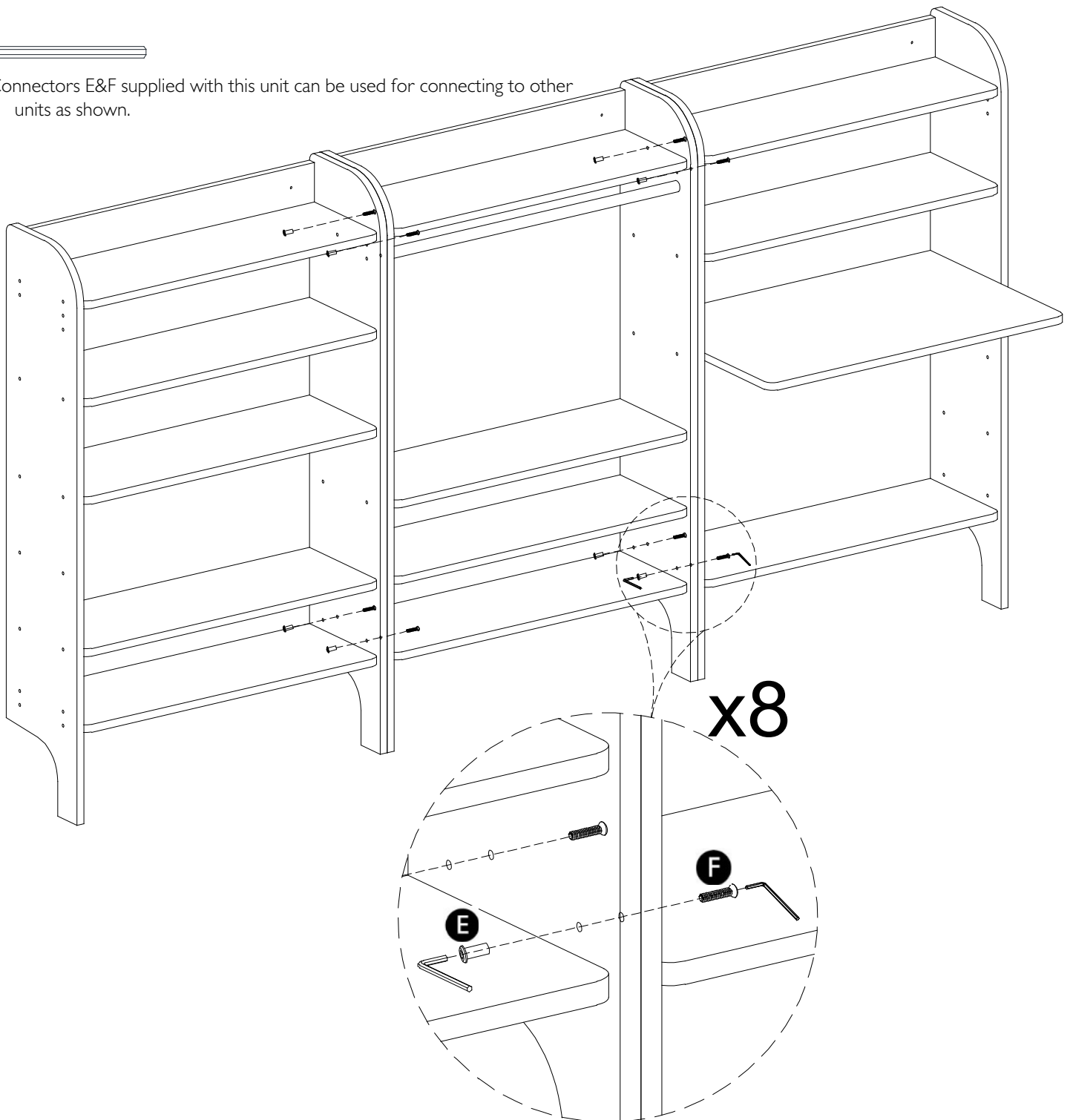

guide to wall mounting and fixings

Warning



In order to prevent overturning this product must be permanently fixed to the wall.

Wall fixing screws are normally not included, since different wall materials require different types of screws / fixings. Please ensure you use the correct screws / fixings for your type of walls and seek professional advice if you are not sure.

Installation shall be carried out exactly according to the instructions provided – otherwise a safety risk can occur if incorrectly installed. Failure of the product due to incorrect fixings is the responsibility of the installer.

Important: When drilling into the walls always check that there are no hidden wires or pipes etc.

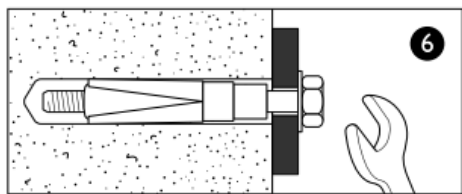
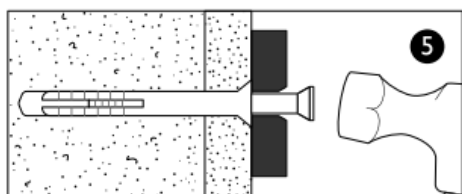
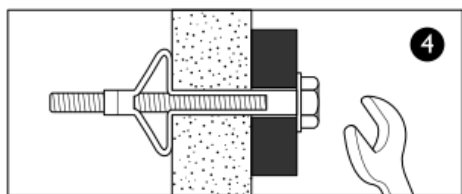
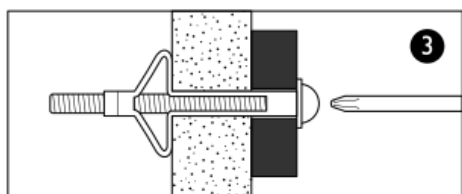
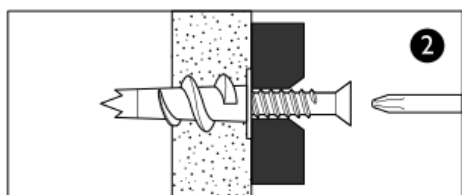
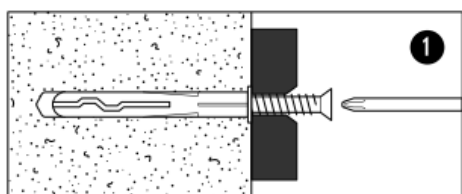

Types of walls

You can use one of the following types of wall plug if your wall is made of brick, breezeblock, concrete, stone or wood.

1 General purpose wall plug

Generally aerated blocks should not be used to support heavy loads, use a specialist fitting in this case. For light loads, general – purpose wall plugs can be used.

2 Plasterboard wall plugs

For use when attaching light loads on to a plasterboard partitions.

3 Cavity Fixing wall plug

For use with plasterboard partitions or hollow wooden doors.

4 Cavity fixing – heavy Duty wall plug

For use when fixing or supporting heavy loads such as shelving, wall cabinets and coat racks.

5 Hammer fixing wall plug

For use with walls stuck with plasterboard. The hammer fixing allows it to be fixed to the wall rather than the plasterboard. Always check the fixing is secure to the retaining wall.

Shield anchor wall plug – heavy Loads

For use with heavier loads such as TV and Hi-Fi speakers and satellite dishes etc.

Care and maintenance



Safety Periodically check all fittings and wall fixings to ensure they have not come loose and retighten as necessary.

Care guide

Care and maintenance

Painted Furniture

All surfaces will change colour and mellow over time. New furniture will initially vary in shade from items that have been previously purchased.

How to care for your furniture

Furniture with a hard lacquer or paint should be dusted with a dry cloth.

Spray polishes are best avoided as they contain silicones which may spoil the furniture's surface by building up over time.

Make sure all surfaces are protected from heat and liquids by mats and coasters. Wipe up spills immediately and ensure that a mat or pad is placed under paper if you are writing.

Our furniture will endure most temperatures in the home but it is best to avoid placing furniture next to heat sources such as radiators or fires. Be particularly careful with solid wood as the lack of humidity caused by central heating can cause damage such as warping.

To prevent scratches and dents please avoid any direct contact to surface and edges with sharp or hard objects. Please use placemats or protective pads where possible. Armrests on office chairs can easily damage the front edge of our desks. Bookcase and even Jeweller bracelets and watches can in certain situations scratch a surface.

Safety instructions

This product is suitable for children in the age range of 3 years.

Periodically check all fittings to ensure none have come loose and re-tighten where necessary. Do not use this item if any components are missing or damaged.

Please take care when handling or moving the furniture as careless handling can cause damage or injury.

Furniture can be dangerous if incorrectly installed. Assembly should be carried out by a competent adult only.

During assembly children should be kept away from the product due to possible risk of injury.

Maximum suitable weight load per shelf 10kg

No liability will be accepted for damage or injury caused by incorrectly installed or assembled furniture.

Retain these instructions for future reference.

Your feedback is very important to us and we would love to hear your comments on your new furniture. Please visit our website to leave a review. Thank you

John Lewis Partnership
171 Victoria Street
London SW1E 5NN
johnlewis.com