

Care instructions

An important part of the microscope is the lens. Therefore, sufficient care must be taken in handling the lens.
If the lens gets dirty or dusty; wipe the lens surface with a clean lens tissue or soft cotton cloth. Do not rub the lens with a finger or dirty cloth.
After it is used, put a cover on the microscope or put it back into the box for screening from dust.
Microscope should be stored in a moisture free place.
Moisture build up on the light causes a reduction in light intensity.
When the microscope is not in use for long periods of time, remove the light source battery.

Warning!



Not suitable for children under 3 years.
Small parts - Choking hazard.
Contains functional sharp points and edges

This product contains a coin battery. A coin battery can cause serious internal chemical burns if swallowed. Dispose of used batteries immediately. Keep new and used batteries away from children. If you think batteries might have been swallowed or placed inside any part of the body, seek immediate medical help.

Remove all packaging / tags before giving to a child.

Recycling and disposal



This symbol indicates that batteries should not be disposed of in the normal household waste but taken to appropriate local recycling facilities, where and when these are available. Never throw batteries in a fire or attempt to open outer casing.

This product should not be treated as normal household waste and it should be recycled. John Lewis do not operate instore take back, but as members of the Distributor Take Back scheme have funded the development and upgrade of recycling facilities across the UK. Please take it to your nearest collection facility or for further details contact your local council or visit www.recycle-more.co.uk.

Please retain this information leaflet for future reference.

John Lewis Partnership
171 Victoria Street
London SW1E 5NN
johnlewis.com



Thank you for purchasing this toy.
Please read the instructions and warnings
carefully before use.

Parts list

23cm (9") Microscope with Eyepiece
and Colour filters
x1 Micro data bank
x1 Micro hatchery
x12 Blank slides
x12 slide covers
x12 Blank labels
x1 Petri Dish with magnifier
x4 Collecting vials
x1 Stirring rod
x1 Tweezers
Instruction manual

1. Eyepiece
2. Focusing Knob
3. Body Tube
4. Revolving Turret
5. Objective Lens
6. Arm
7. Stage
8. Clip
9. Mirror
10. Illuminator Lamp
(Light Source Lamp)
11. Base

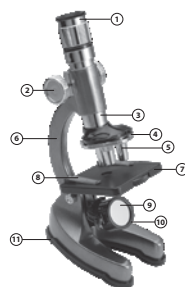

Instructions for use

1. First tilt the arm and adjust the position of the reflector so that the light is fully caught by the mirror.
2. When the light is fully reflected by the mirror, as can be seen through the eyepiece, the microscope will be ready for observation.
3. Next, put the prepared slide on the stage and fix it in place with the clips.
4. Now decide what magnification to use. The greater the length of the objective lens the greater the magnification. Observation is generally made by starting at a low setting.
5. In order to change the magnification turn the revolving turret until you hear a click.
6. Using the focusing knob, lower the lens as closely as possible to the prepared slide without actually making contact. Then, while looking through the eyepiece, turn the knob in the opposite direction until the image comes into focus.
7. If the light intensity is low or the image is not clear at high magnification rotate the illuminator lamp upward. The light automatically turns on when rotated.

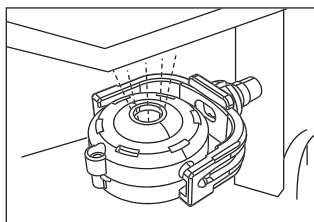
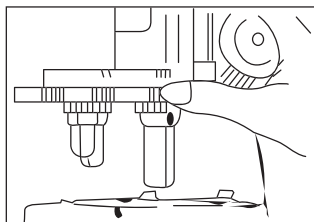
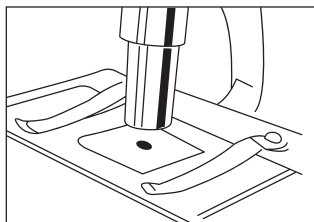
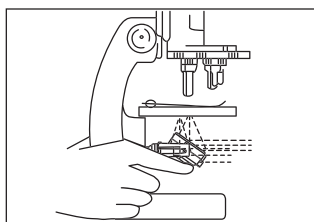

Changing the batteries

Requires 1 x CR2032 battery included.

1. Unscrew the lamp cover with a screwdriver to take off. (Figure 1)
2. Insert the battery into the battery compartment carefully the correct (+) and (-) positions. (Figure 2)
3. Replace the lamp cover and screw it back into place. (Figure 3)

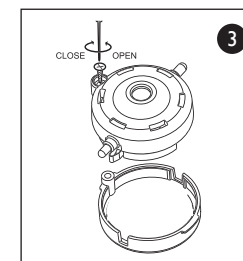
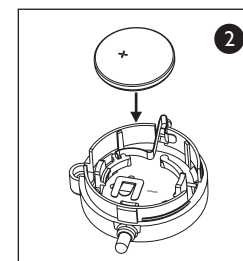
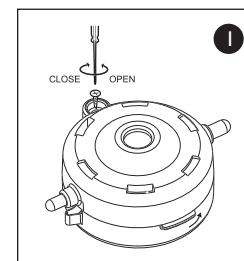

Battery safety

Batteries should be removed and replaced by adults only.

Only use recommended batteries or those of the same or equivalent type.
Do not mix old and new batteries or batteries of different types.
Batteries are to be inserted with the correct polarity.
The supply terminals are not to be short-circuited.
Remove exhausted batteries from item.
Remove batteries if equipment is not used for extended periods of time.
Rechargeable batteries are to be removed from the item before being recharged.
Rechargeable batteries are only to be charged under adult supervision.
Do not attempt to recharge non-rechargeable batteries.
Batteries contain substances that may be harmful to the environment and human health.
Keep out of the reach of children and seek immediate medical help if swallowed.

Advice for supervising adults

Read and follow the instructions and safety rules. Keep them for reference.
This Microscope set is for use only by children over 8 years old.
Because children's abilities vary so much, even within age groups, supervising adults should exercise discretion as to which preparations are suitable and safe for them. The instructions should enable supervisors to assess any preparation to establish its suitability for a particular child.
The supervising adult should discuss the warnings and safety information with the children before commencing the preparations.

Safety

Keep young children and animals, away from the experimental area.
Wear eye protection where necessary.
Store microscope sets out of reach of young children.
Clean all equipment after use. Wash hands after use.
Do not use any equipment which has not been supplied with the set.
Do not eat, drink or smoke in the experimental area.
Do not put food samples back in original container. Dispose of immediately.
Make sure that all containers are fully closed and properly stored after use.