



AMARA 5 LIGHT CEILING FITTING

IL2905

Thank you for buying this **Amara** ceiling fitting.
Please read the instructions and warnings carefully before use to ensure safe and satisfactory operation of this product.

This product is Class II therefore no earth is required

Warnings

- * It is recommended that this fitting is installed by a qualified electrician.
- * This fitting should be fitted in accordance with IEE Wiring Regulations and the Building Regulations.
- * To prevent electrocution switch off at the mains supply before installing or maintaining this fitting. Ensure other persons cannot restore the electricity supply without your knowledge.
- * If you are in doubt please consult a qualified electrician.
- * To avoid damage to concealed wiring during installation, establish the direction of the supply cable before drilling fixing holes.
- * This fitting should be fitted to a lighting supply with protected 5 amp fuse or equivalent circuit breaker.
- *  Indicates that the fitting is suitable for mounting on normally flammable surfaces.
- * Always be sure to use the correct type and wattage of bulbs as indicated on the fitting. Never exceed the wattage stated.
- * When changing the bulb, always switch off at the mains and allow the old bulb to cool down before handling. Dispose of used bulbs carefully.
- * This fitting is designed for use with self-shielded tungsten halogen lamps only = 

Instructions for use

1. Ensure the house electricity supply is off at the fuse board.
2. If removing an existing fitting, first note down all wiring connections.
3. Remove mounting bracket from fitting by removing the retaining screws (washers) and retain for later.
4. Using mounting bracket as a template, mark and then drill the fixing holes in the ceiling (ensure holes are drilled into a secure joist). **Take care not to damage wiring.**
5. Attach mounting bracket to the mounting surface using suitable fixings. Make sure no wires are trapped in the process.
6. Lever open the enclosed connector block using a small flat bladed screwdriver. Make electrical connections as follows:
Connect supply live (normally brown or red) to fitting live (marked "L") on the terminal block.
Connect supply neutral (normally blue or black) to fitting neutral (marked "N") on the terminal block.

Please note: No earth should be connected to any part of this fitting. If any earth wires are present please terminate these in a separate terminal block (not supplied) to ensure that continuity is maintained for the household earth circuit.

Ensure electrical connections are tight and no loose strands of wire are left out of connector block and that the rubber sleeve is correctly located and covering the supply cable.

7. Carefully offer fitting over mounting bracket then secure in place with the screws and any washers removed earlier.
8. Fit the glass. Remove the metal shade ring from the lampholder, place the glass over the lampholder and using the shade ring tool provided refit the metal shade ring to the lampholder ensuring the glass is secure. Please do not overtighten.
9. Fit the bulbs, type and wattage as indicated on the fitting. **The wattage indicated must not be exceeded.** Do not touch halogen lamps with bare hands as this will shorten their life.
10. Switch on the electricity supply at the fuse board.

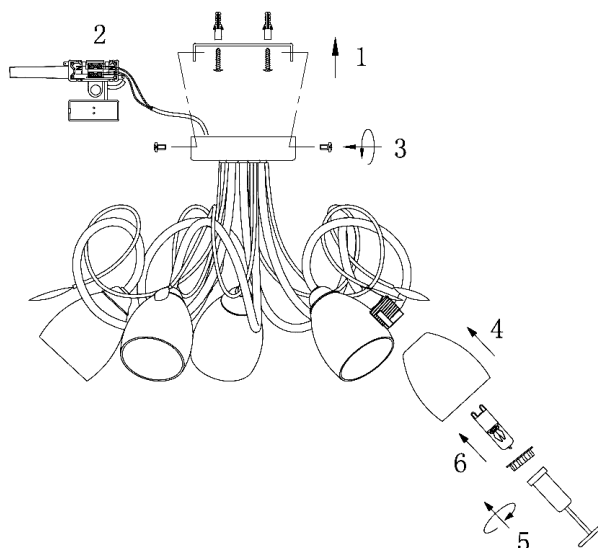

Please retain this information leaflet for future reference

GENERAL INFORMATION

This fitting is designed for internal use only

Do not use polished or abrasive cleaner – just a soft dry cloth.