

Product information

- Indoor use only
- Dimmable
- Replacement bulbs should be the same type and rating, available from John Lewis Partners or other established brands
- Clean the fitting with a soft dry cloth. Do not use abrasive chemical cleaners as this will damage the finish
- Glass parts - Use a damp cloth. Do not use abrasive materials as these will damage the finish. Take care when handling glass parts to avoid damage or injury

Aftercare and Troubleshooting

You've switched on the light, but it's not working:

1. Check your power supply is switched on
2. Turn off the light and check that the bulb is inserted correctly
3. Check the bulb is still in working order

If there are technical issues with this product that you can't solve, please contact your nearest John Lewis & Partners shop or call Technical Support on 03301 230106.

Specification

Max power: 1 x 6W
Recommended bulb:
6W LED E14 Candle bulb for maximum brightness.
Lower wattages are also suitable.
Rated input: 220 –240V, 50Hz
Bulbs not included
IP rating: 20
Weight: 1.19kg

5-year guarantee

At John Lewis & Partners we test every light to high quality standards. That means we can offer you a 5-year guarantee.

Recycling

This symbol  indicates that this product should not be treated as normal household waste and it should be recycled. John Lewis & Partners do not operate instore take back, but as members of the Distributor Take Back scheme have funded the development and upgrade of recycling facilities across the UK. Please take it to your nearest collection facility or for further details contact your local council or visit www.recycle-more.co.uk.



TESSA UPLIGHTER USER GUIDE

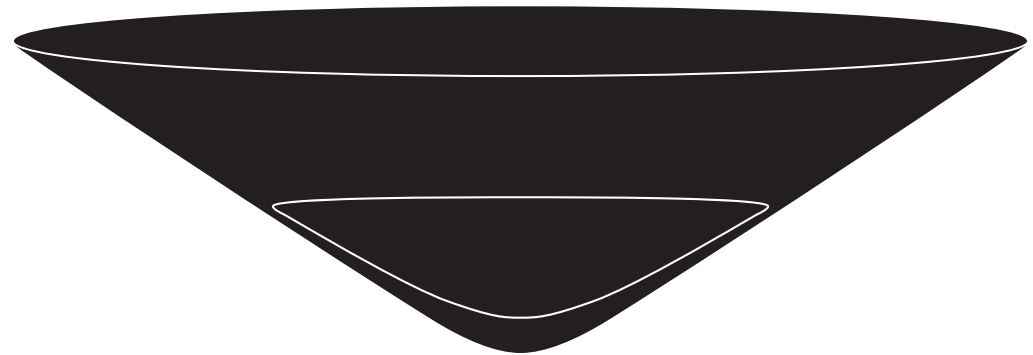

John Lewis plc
SW1V 2QQ
johnlewis.com

Made in China



21/11/2024

Please retain these instructions for future reference.



Product Code:
70243516

Thank you for purchasing this Tessa Wall Light. Please read the instructions carefully before use to ensure safe and satisfactory operation of this product.

Warnings!



This product is Class II (double insulated) and must not be earthed. If there are any incoming earth cables, they must be joined together and well insulated with good quality insulation tape. This is to ensure earth continuity throughout your property.

Please read these instructions carefully before commencing any work. It is recommended that this fitting is installed by a qualified electrician.

Install in accordance with the IEE Wiring regulations and the Building Regulations.

To prevent electrocution switch off at mains supply before installing or maintaining this fitting. Ensure other persons cannot restore the electrical supply without your knowledge. If you are in any doubt, please consult a qualified electrician.

This light fitting should be connected to a 5 amp fused circuit.

If replacing an existing fitting, make a note of the connections.

Parts List

Light Fitting		1	Nuts		2
			Washers		2
			Bolts		2
			Wall plugs		2

Installation Instructions

Carefully unpack the carton, making sure all the parts are present before assembly.

Make sure you have the following items which are required to install this light fitting:

Small electrical screwdriver, cross head screwdriver & insulation tape.

The installation of this fitting will be much easier with the help of an assistant.

Step 1

Before removing the existing fitting, **carefully note the position of each set of wires.**

Step 2

Check hole spacings on rear of product (approx 85mm). Drill out holes in wall, ensuring supply wiring is in the centre of fixing hole spacing then fit wall plugs. The wall plugs supplied are only suitable for masonry. Obtain suitable fixings for plasterboard. Screw in special fixing screws as shown in diagram. Take care not to damage concealed wiring and pipes.

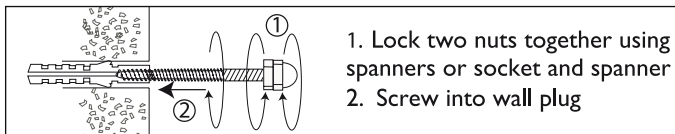

Step 3

Having identified the household wiring from your existing light fitting, connect to the connection block inside the product in the following way:

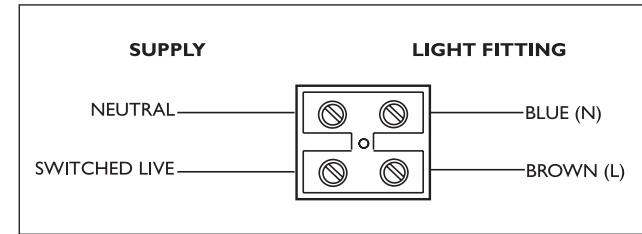

Check that.....

You have correctly identified the house wires. The connections are tight.

No loose strands have been left out of the connection block.

Cover is securely refitted.

Step 4

Attach the product to the fixing screws. Use the adjustment nut to ensure the product sits flush against the wall with the terminal box in the recess (see diagram 4). Add rubber washers and secure with dome nuts (see diagram 5) - Do not over tighten. Ensure the wall back is fitted in the correct orientation (see diagram 6).

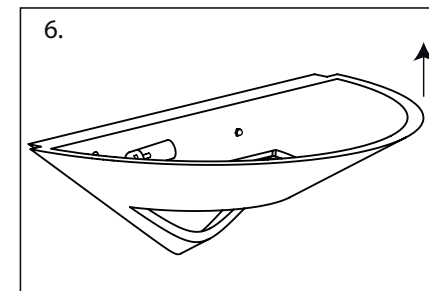
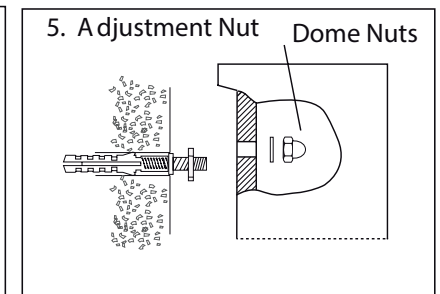
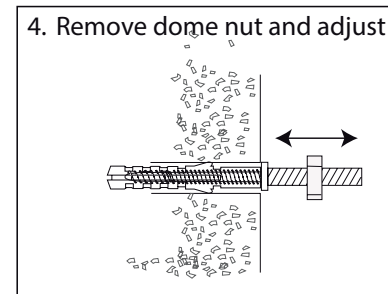

Step 5

Replace fuse or circuit breaker and switch on. Your light is now ready for use.