

BOSA TABLE LAMP

INFORMATION LEAFLET

Thank you for purchasing this table lamp. Please read the enclosed information carefully before use to ensure safe and satisfactory operation of this product.

Warnings

This is a Class II product and must NOT be earthed. The lamp must be protected by a 3 amp fuse in the mains plug. If you are in any doubt, please consult a qualified electrician. This product is suitable for indoor use only.

For your safety, always switch off the supply before cleaning or adjusting.

If the mains cable becomes damaged it must only be replaced by a technically competent, qualified person.

Always use correct type and wattage bulb. Never exceed the wattage stated.

This product is dimmable when used with dimmable bulbs.

This product contains glass so care must be taken when fitting or handling to prevent personal injury or damage to the product.

Product assembly

Step 1

Carefully unpack the carton, making sure all the parts are present before assembly.

Step 2

To attach the shade (A) first remove the shade ring (B) from the threaded lampholder. Place the shade over the lampholder and secure in place by refitting the shade ring. Tighten to secure in place but do not overtighten.

Step 3

Fit the recommended bulb (C). Max. 7W LED E27 GLS.

Step 4

Your table lamp is now ready for use.

Plug in and operate the on/off dimmer by touching the lamp base (D). (One touch low light level, second touch brighter, third touch brightest and forth to switch off).

Please note: Some bulbs may cause flickering when used on the lowest setting. This is not a fault of the product but the type of bulb used.

Try changing the bulb and ensure the bulb used is dimmable.

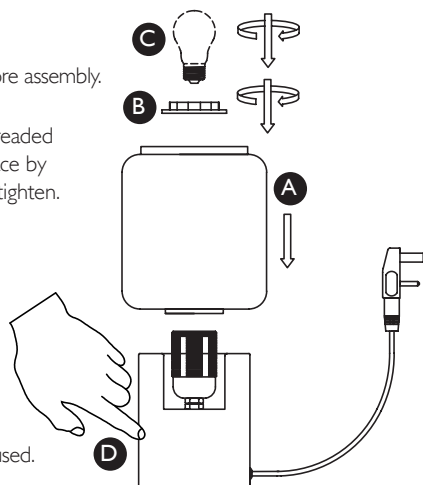

Recycling

This symbol  indicates that this product should not be treated as normal household waste and it should be recycled. John Lewis & Partners do not operate instore take back, but as members of the Distributor Take Back scheme have funded the development and upgrade of recycling facilities across the UK. Please take it to your nearest collection facility or for further details contact your local council or visit www.recycle-more.co.uk.

Cleaning

Clean the fitting with a soft dry cloth. Do not use abrasive chemical cleaners as this will damage the finish.

Glass parts - Just use a slightly damp cloth. Do not use abrasive materials as these will damage the finish. Take care when handling glass parts to avoid damage or injury.

John Lewis plc
SWIV 2QQ
johnlewis.com



Product Code:
70670422
23/09/2025

Made in China

Please retain this information for future reference.