

Arc Toy Storage Box

Stock number: 393 70302

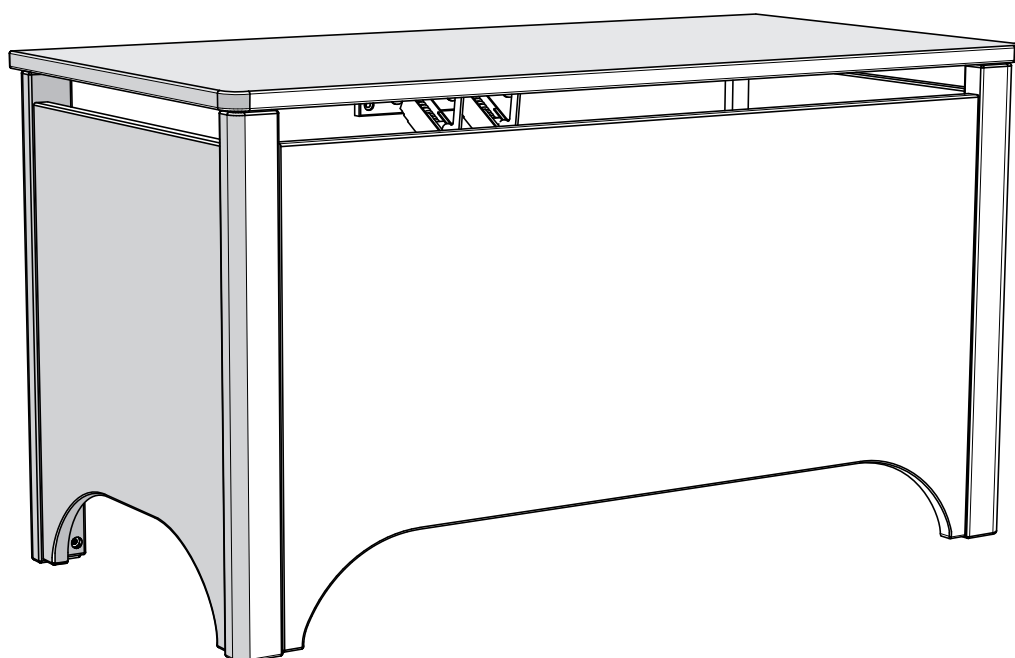

IMPORTANT RETAIN FOR FUTURE REFERENCE READ CAREFULLY

H44.8 W 80.6 D 39.8cm

Introduction

Thank you for purchasing this Arc Toy Storage Box.
Please read the instructions carefully before using.
This product has been designed, manufactured and tested to comply with FIRA/FRQG C001: 2021 , FIRA/FRQG C004:2016 +A1 2017.

Tools required

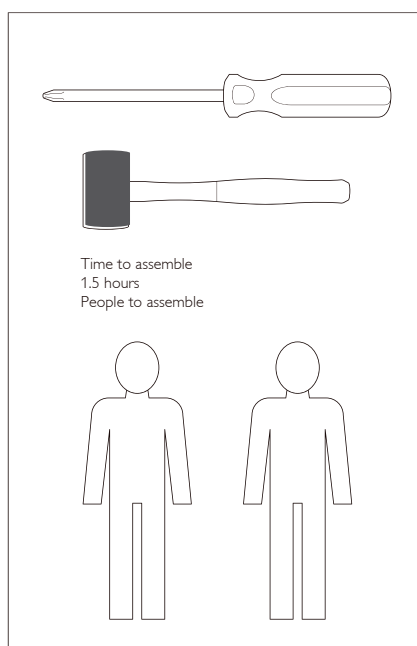

Important safety information

⚠ Warning: In order to prevent overturning, this product must be used with the wall attachment device provided.

- Adult assembly required.
- Unassembled product contains small parts which may present a choking hazard.
- Assemble and use on a flat and level surface.
- Children should be kept away from the product during assembly to avoid any possible risk of injury.
- This product is suitable for children in the age range of 3 years plus.
- Maximum weight load 30Kg. Do not overload. Do not sit, stand or jump on the top.
- DO NOT place this product near a window as it can be used as a step by the child and cause the child to fall out of the window.
- DO NOT place this product near a window where cords from blinds or curtains could strangle a child.
- Be aware of the risk of open fires and other sources of strong heat in the vicinity of the product.
- DO NOT use power tools in the assembly of this product as there is a risk of over-tightening and consequently splitting of the wood.
- Check all fixtures and fittings regularly and tighten as necessary.

WARNING. Do not use this bed if any part becomes broken, torn or missing. Return small or medium items by post or to John Lewis & Partners and Waitrose & Partners shops.

Warnings

- ⚠ The product should only be used on firm, level ground.
- ⚠ Keep small parts out of reach of children.
- ⚠ Ensure the product is fully assembled as illustrated before use.
- ⚠ Care should be taken that no screws are loose because a child could trap parts of their body, or clothing (e.g. strings, necklaces, ribbons, dummies, etc) which could pose a risk of strangulation.
- ⚠ Ensure that the wall bracket is used to securely attach the dresser to the wall to prevent tipping.
- ⚠ Any additional or replacement parts must only be obtained from John Lewis & Partners.
- ⚠ During assembly children should be kept away from the product due to possible risk of injury.
- ⚠ Do not use this item if any components are missing or damaged.

Do's

- ✓ Check the pack and make sure you have all the parts listed.
- ✓ Check all screws or bolts are tightened and inspect regularly.
- ✓ Make sure the legs remain in contact with the ground at all times.

Don'ts

- ✗ Do not over tighten screws or bolts.
- ✗ Do not stand on the product.
- ✗ Do not use power tools to construct as over tightening and panel failure may occur.

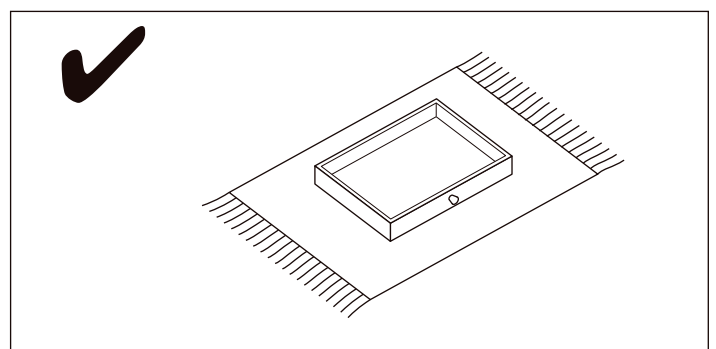
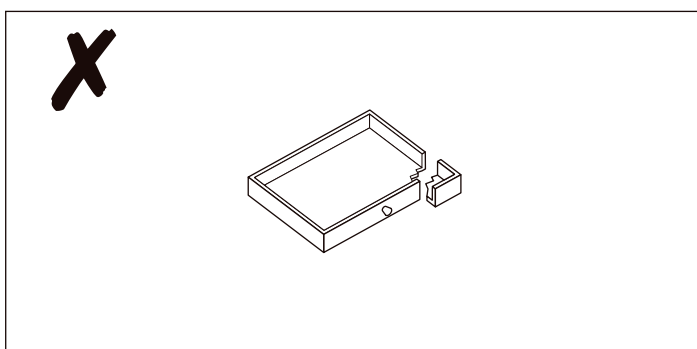
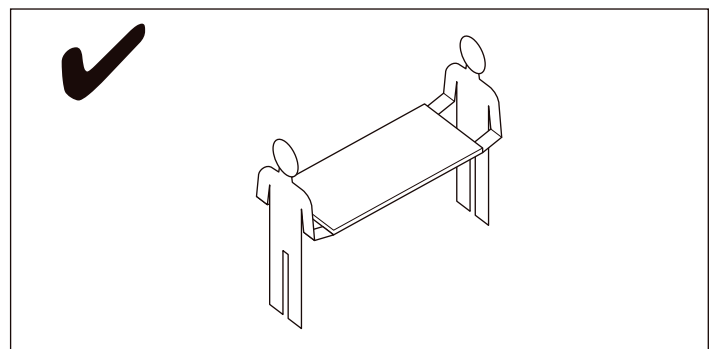
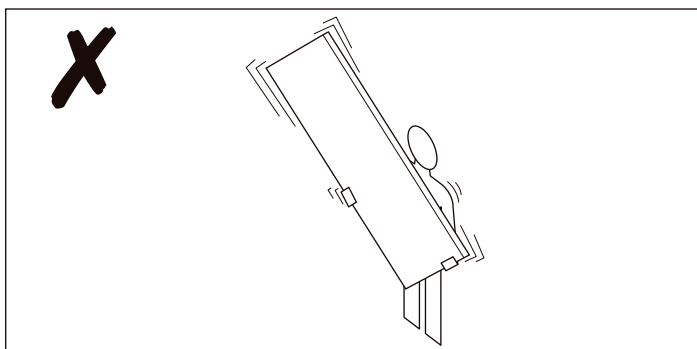
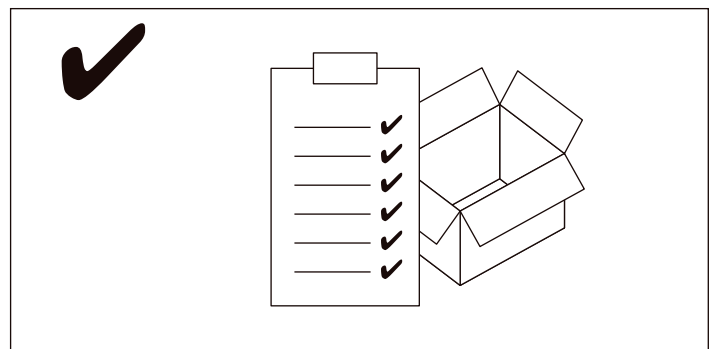
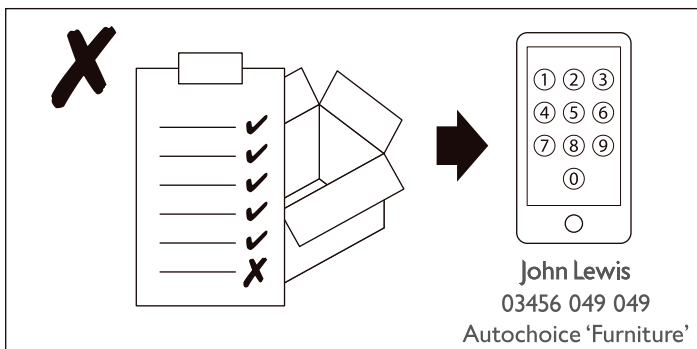

Your Toy Storage Box

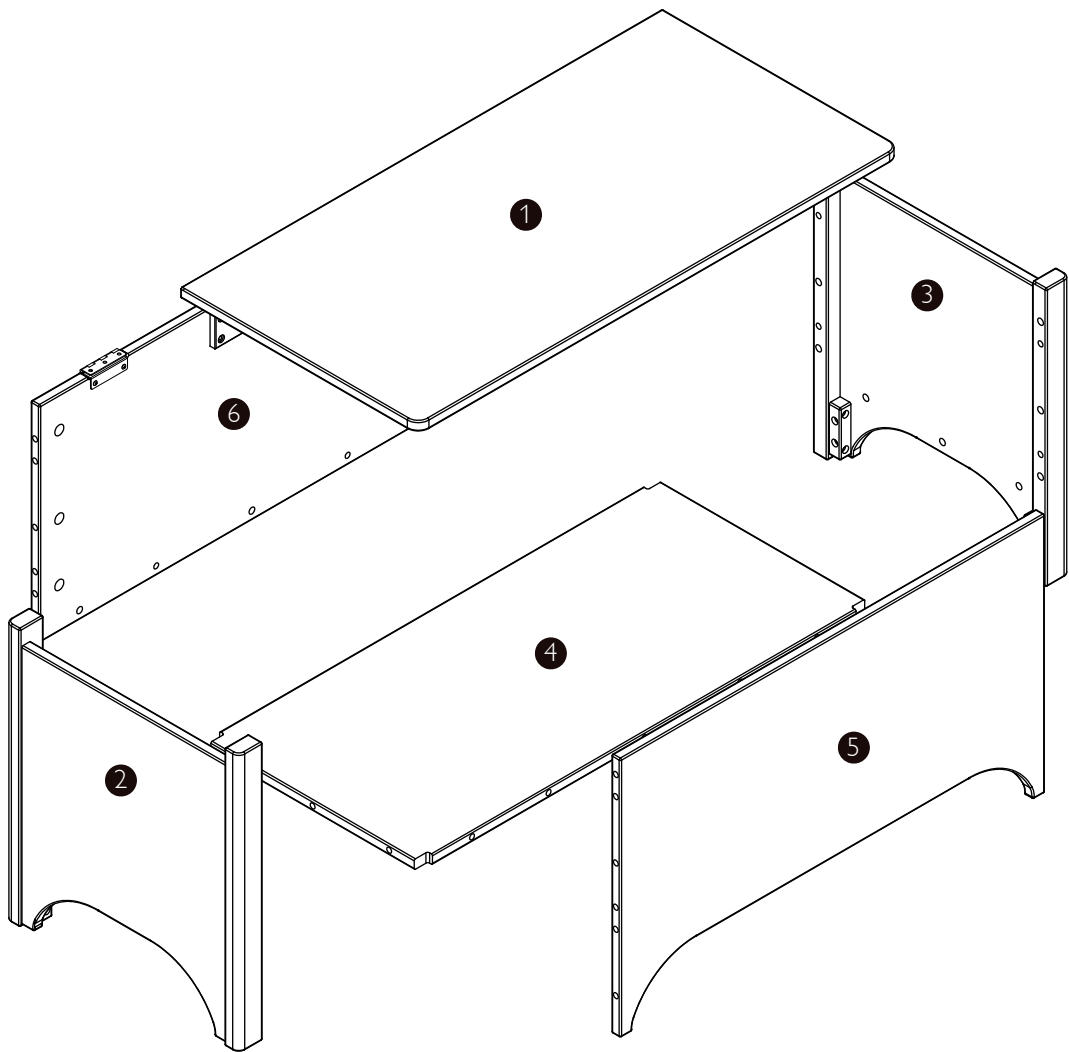

Ref	Description	Dimensions	Qty
①	Top panel	806mm x 400mm x 24mm	1
②	L/H side panel	431mm x 390mm x 40mm	1
③	R/H side panel	431mm x 390mm x 40mm	1
④	Bottom panel	753mm x 356mm x 15mm	1
⑤	Front panel	710mm x 403mm x 15mm	1
⑥	Back panel	710mm x 343mm x 24mm	1

Internal dimensions
 Stock number : 393 70302
 Arc Toy Storage Box overall size: H44.8 W 80.6 D 39.8cm

Fixtures and fittings

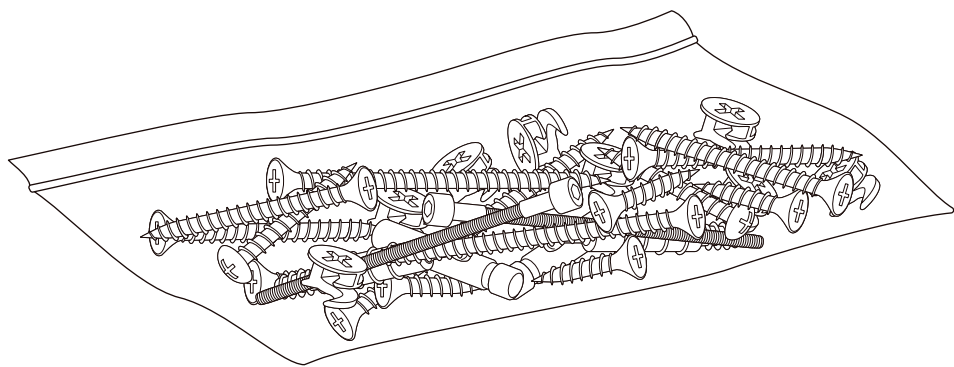

Fixtures and fittings
supplied (actual size)

Ref	Description	Dimensions	Qty	mm	
				0	10 20 30 40 50 60 70
A	Wooden dowels	8mm x 30mm	14		
B	Screw	3.0mm x 9mm	8		
C	Screw	Ø6mm x M5 x 12mm	6		
D	Cam heads	15mm x 11mm	24		
E	Cam rods	5mm x 33mm	24		
G	Felt Pads		2		

Fixtures and fittings
supplied (not actual size)

Ref	Description	Dimensions	Qty	
F	Safety Hinge		2	

Product assembly

Arc Toy Storage Box

Step 1

Parts, fittings and tools

E 2 3 5 6

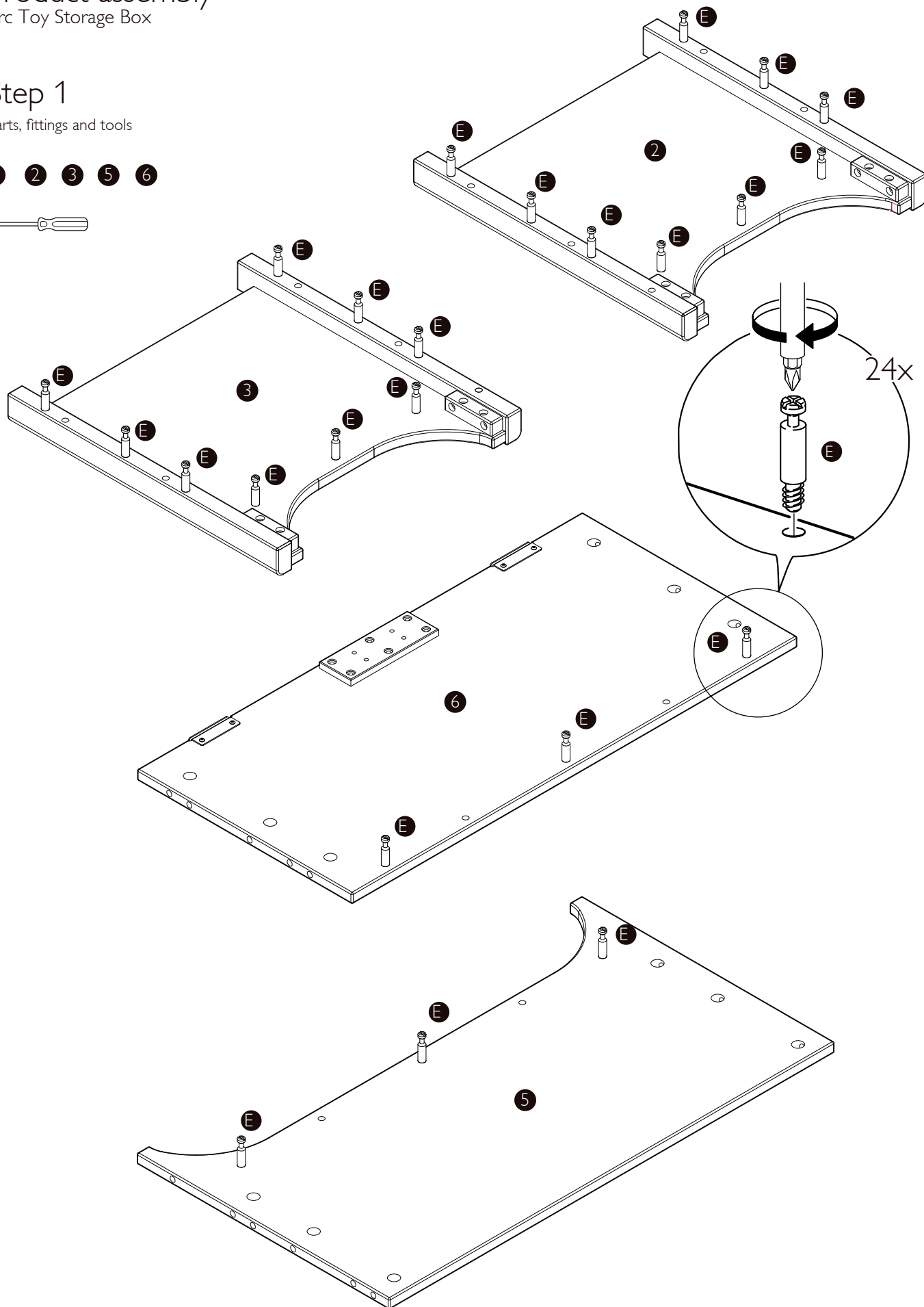
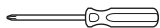

Product assembly
Arc Toy Storage Box

Step 2

Parts, fittings and tools

A D 4 5 6

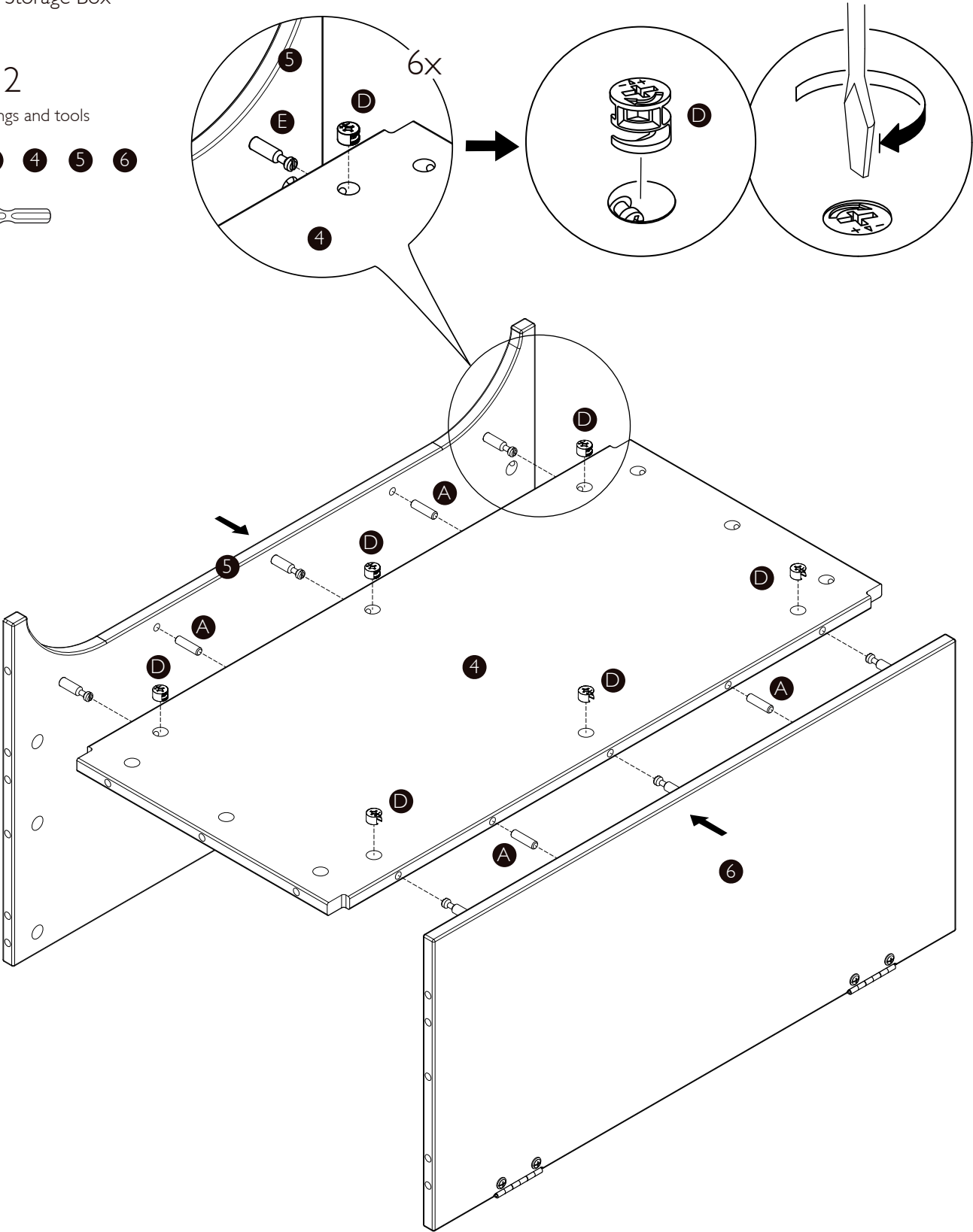
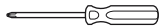

Product assembly

Arc Toy Storage Box

Step 3

Parts, fittings and tools

A D 2 3 4
5 6

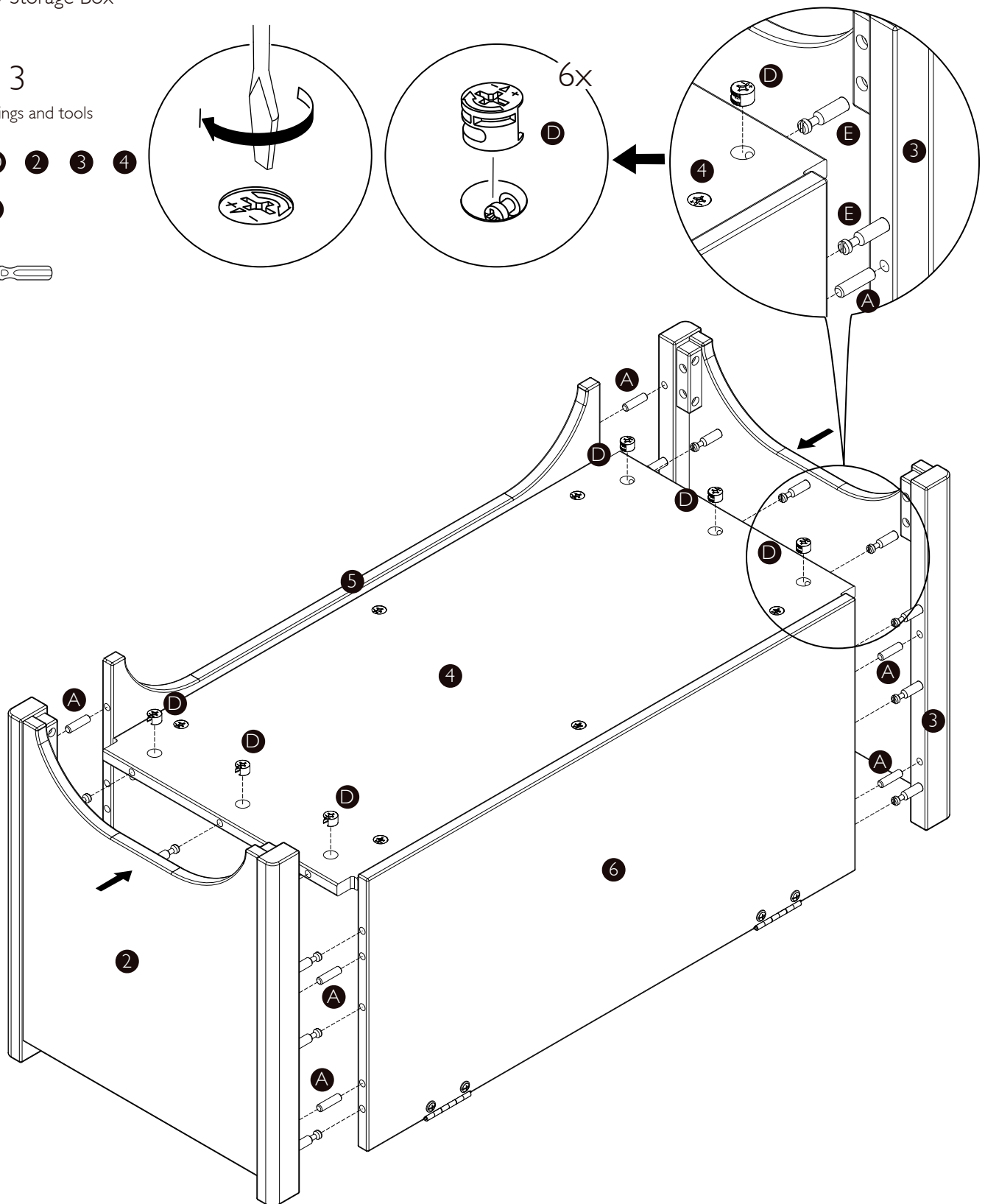
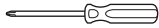

Product assembly
Arc Toy Storage Box

Step 4

Parts, fittings and tools

- D
- 2
- 3
- 5
- 6

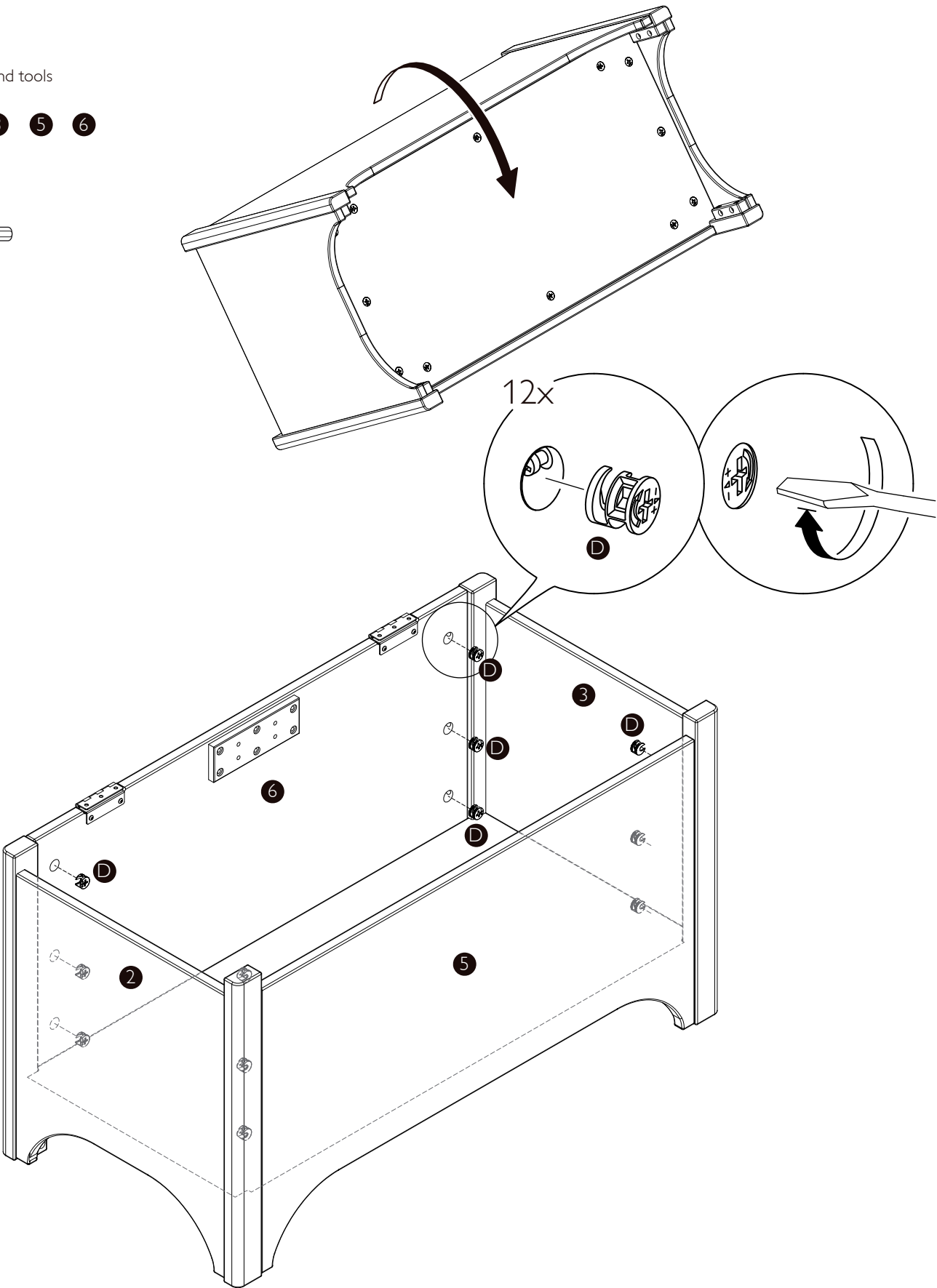
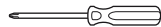

Product assembly
Arc Toy Storage Box

Step 5

Parts, fittings and tools

B F 6

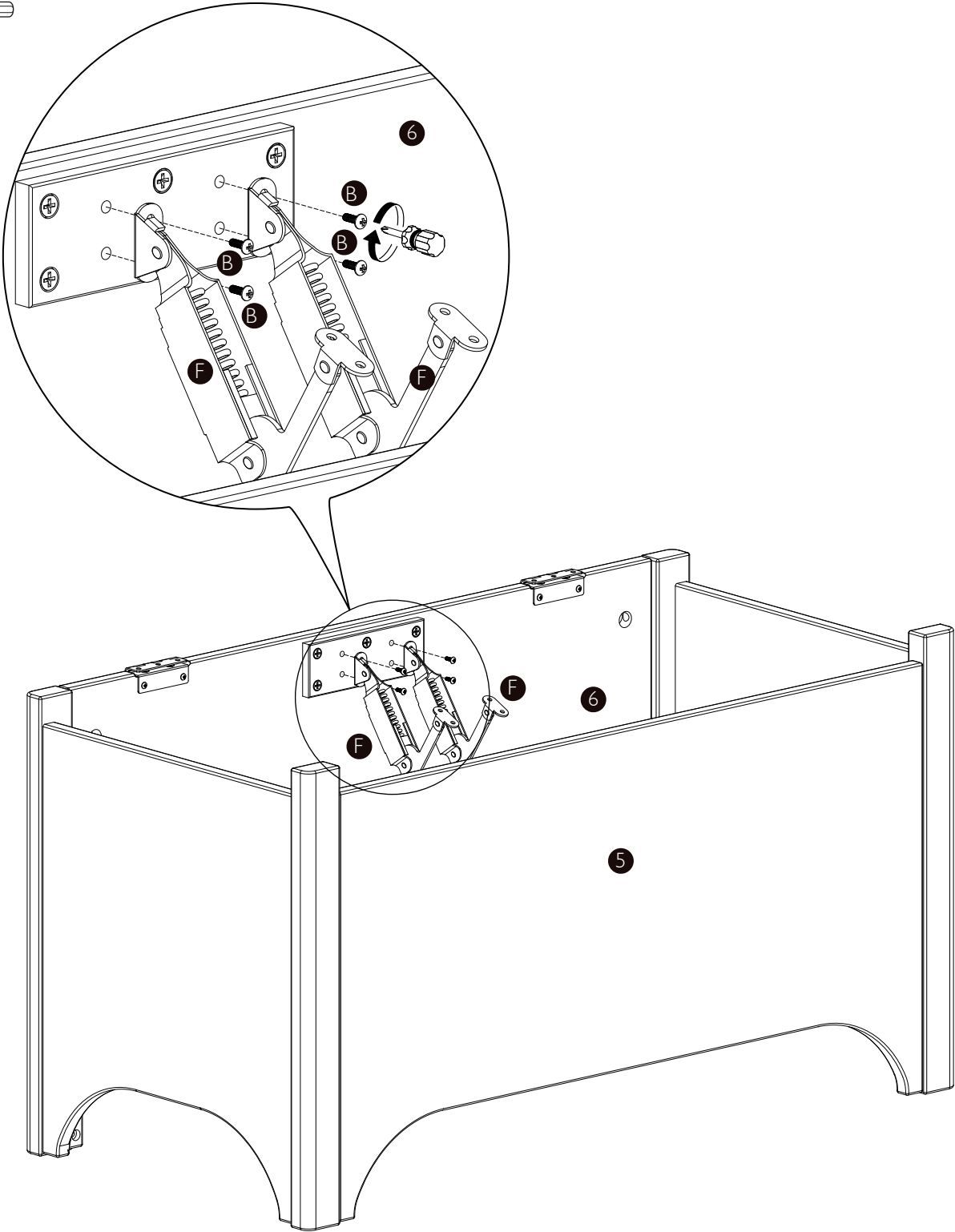
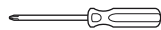

Product assembly

Arc Toy Storage Box

Step 6

Parts, fittings and tools

B C F G 1 6

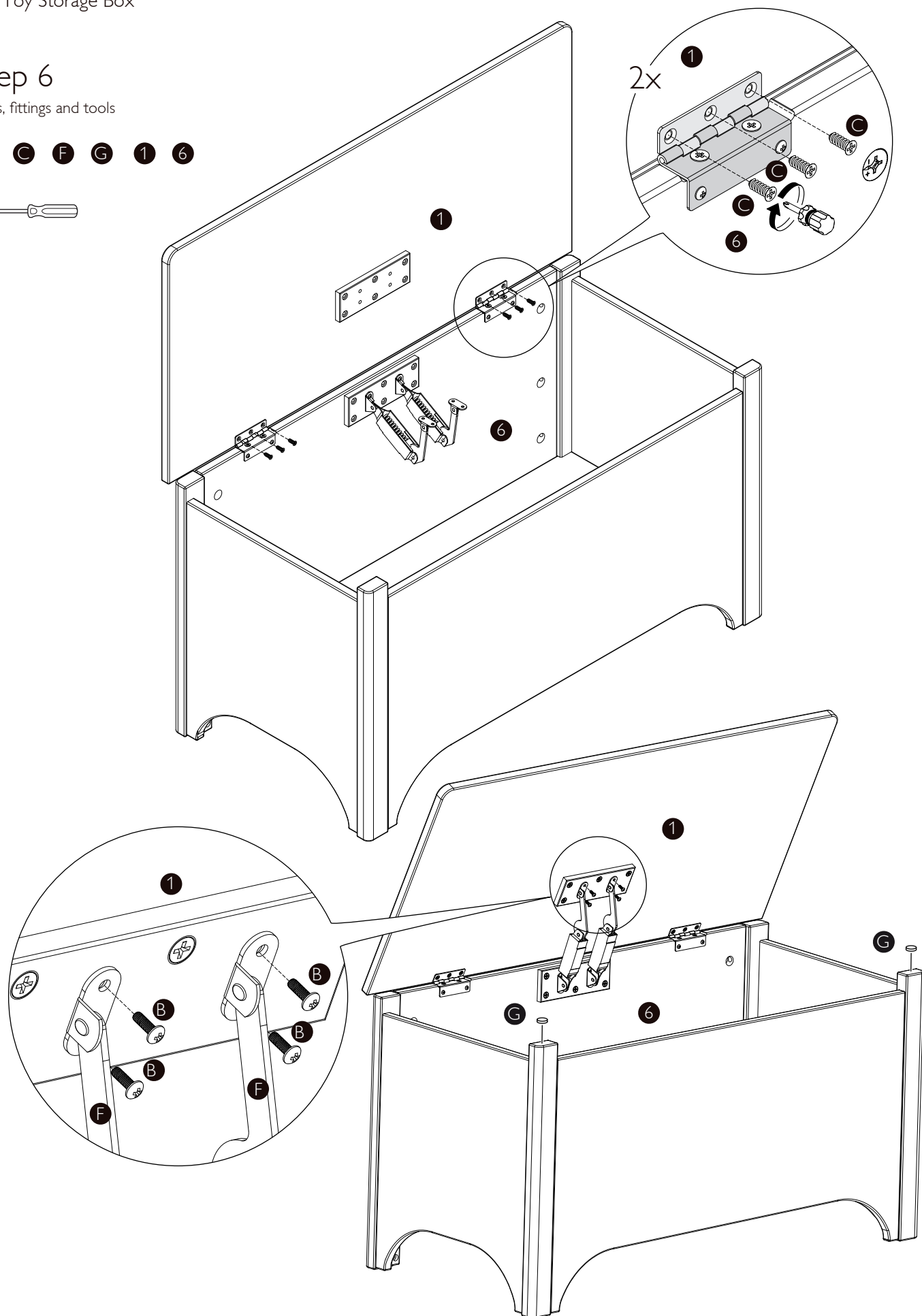
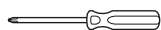

Care and maintenance

Your furniture may be cleaned by wiping with a damp cloth and drying with a soft clean cloth.

Do not use abrasives, bleach, alcohol or ammonia-based household polishes.

Take care when handling or moving the furniture. Careless handling may cause damage.

Regularly check that all fixings are tightened and that there are no broken or damaged parts.

Safety notes

Warning: Do not leave your child unattended.

Keep children clear during assembly as pack contains small parts which may present a choking hazard.

All assembly fixings should always be tightened properly. Care should be taken that no screws are loose because a child could trap parts of their body, or clothing (e.g. strings, necklaces, ribbons, dummies, etc) which could pose a risk of strangulation.

Be aware of the risks of open fires and other such sources of strong heat, such as electric bar fires, gas fires, etc. in the near vicinity of this product.

Do not use this product if any of the parts are broken, torn or missing.

Any additional or replacement parts can only be obtained from the manufacturer or the distributor.

Never drag furniture when moving it, always lift it.

Periodically check all fixings to ensure none have come loose and retighten when necessary.

Furniture can be dangerous if incorrectly installed. Assembly should be carried out by a competent person only.

No liability will be accepted for damage or injury caused by incorrectly installed or assembled furniture.

Retain these instructions for future reference.

Your feedback is very important to us and we would love to hear your comments on your new furniture. Please visit our website to leave a review. Thank you.