

Please retain these instructions for future reference.

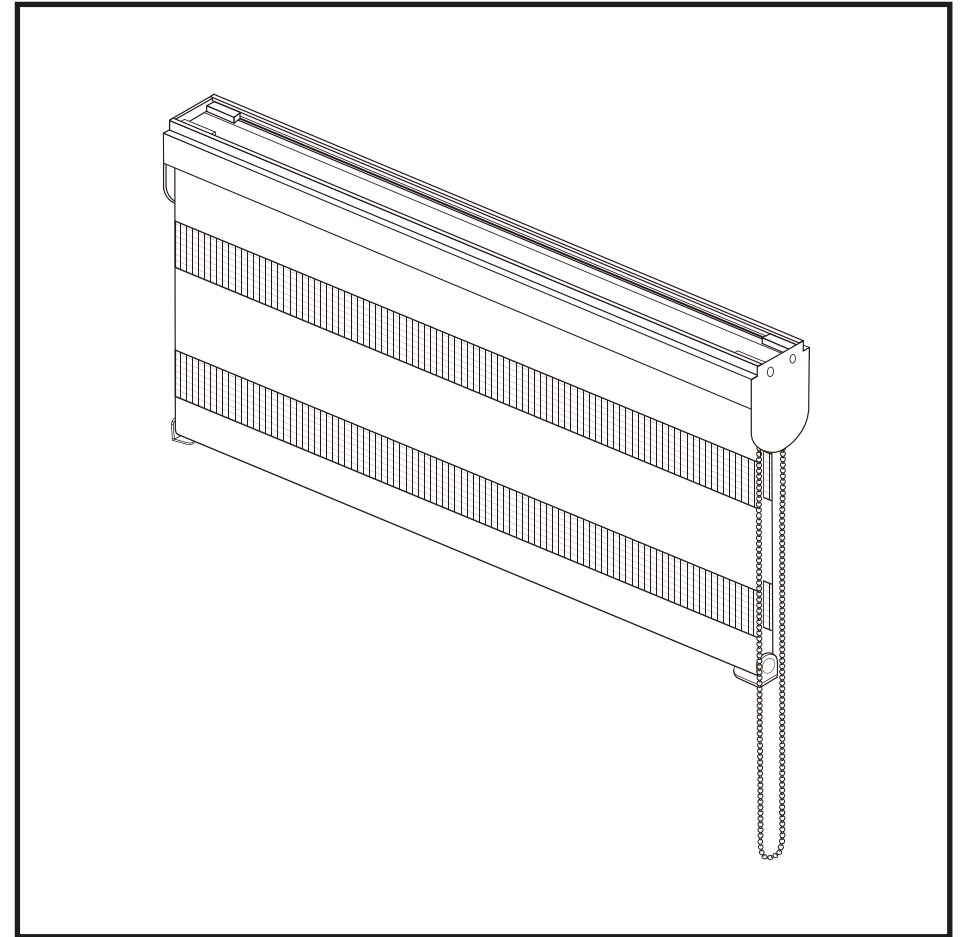

# DAY & NIGHT ROLLER BLIND

INSTRUCTION MANUAL

---

John Lewis Partnership  
171 Victoria Street  
London SW1E 5NN  
johnlewis.com

Made in China  
Batch code:

JOHN LEWIS  
& PARTNERS

## INTRODUCTION

**Thank you for purchasing this Roller blind.  
Please read the instructions carefully before  
use to ensure safe and satisfactory operation  
of this product.**

It is recommended that this blind should only be installed by persons competent in DIY. At John Lewis, we are committed to making great products possible. From our in-house Design Team, to our Buyers, we work together to bring great design to life. Our Product Technologists work collaboratively with our Buyers and suppliers to ensure the legality, safety and quality of the product we sell. We are all committed to designing and developing products to the highest industry standards.

We hope you are happy with your product and welcome any feedback or comments you may have.

## VIDEO INSTRUCTIONS

Scan the QR code to link to our online videos that guide you in getting a perfect fit for a Roller blind. Alternatively follow the link [johnlewis.com/blindassembly](http://johnlewis.com/blindassembly)



## TOOLS REQUIRED

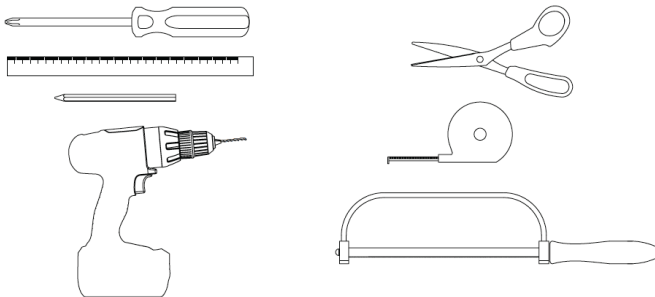

## PEOPLE TO ASSEMBLE

One person

## TIME TO ASSEMBLE

1 Hour

## WARNINGS



- ⚠ Small parts – choking hazard.
- ⚠ Keep small parts out of reach of children
- ⚠ Ensure the product is fully assembled as illustrated before use.
- ⚠ Young children can be strangled by loops in pull cords, chains, tapes and inner cords that operate the product.
- ⚠ To avoid strangulation and entanglement, keep cords out of reach of children.
- ⚠ Cords may become wrapped around a child's neck.
- ⚠ Move beds, cots and furniture away from window covering cords.
- ⚠ Do not tie cords together. Make sure cords do not twist and create a loop.
- ⚠ The safety clips should be positioned high enough to be out of reach of small children yet accessible to adults.
- ⚠ All safety clips for blinds need to be fixed to a solid surface using a screw and fixing suitable for the wall or surface material – see guide to wall mounting and fixings on the last page. These items should not be glued or stuck in place.
- ⚠ The head rail should not be installed less than 1.5m from the floor.

## DO'S

- ✓ Please read all safety warnings and installation information fully before installation.
- ✓ This product should be fitted in accordance with the manufacturers fitting instructions.
- ✓ Check the pack to make sure you have all the parts listed.
- ✓ Take care when drilling on glazed tile surfaces in case the drill slips.
- ✓ Check that all screw and bolt assembly fittings are tightened and inspect on a regular basis.
- ✓ Use the safety device provided.
- ✓ Please read our guide on wall mounting and fixing on the inside back cover.

## DONT'S

- ✗ Do not over tighten screws or bolts.
- ✗ Do not use power tools to construct as over tightening and failure may occur.

## PARTS LIST

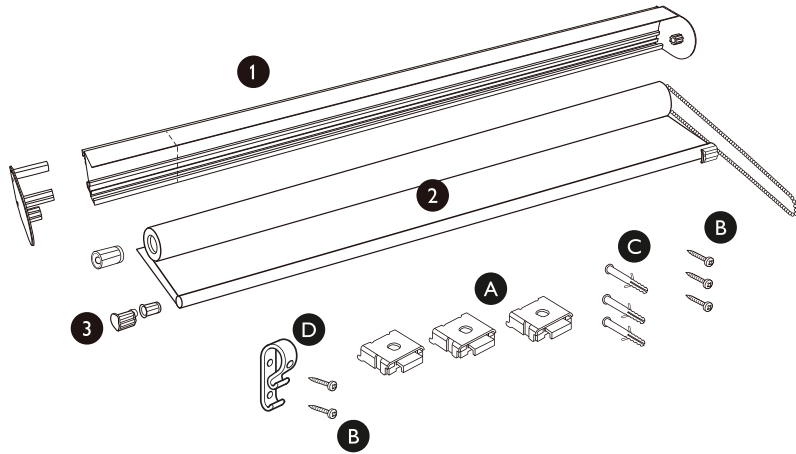

Code	Item	Quantity	Dimension	Illustration
1	Headrail	x1		
2	Fabric	x1		
3	Bottom Bar	x1		
A	Metal fixing brackets	x3(Product Width>150) x2(Product Width≤150)	40x24x9mm	
B	Screws	x3(Product Width>150) x2(Product Width≤150)	Ø4x30mm	
	Screw (safety clip)	x2	Ø4x20mm	
C	Wall Plugs	x3(Product Width>150) x2(Product Width≤150)	Ø6x30mm	
D	Safety clip	x1	50x16x18mm	

## BLIND POSITIONING

### 1. Decide on position of your blind

**Outside recess mount**  
Decide on the position of the blind so that it overlaps on both sides equally, at least 5cm.

**Inside recess mount**  
You may need to trim the blind down to fit inside the recess. Recess needs to be 7.5cm deep in order to fit in the blind mechanism. Also check how much space any window handles etc need.

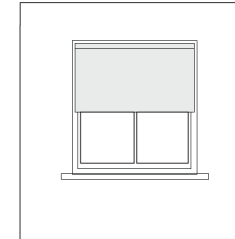
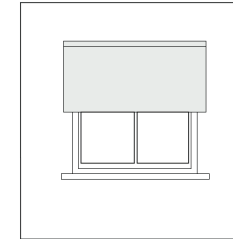

### 2. Measuring

#### Inside window recess

Measure both the width and the length of the space to get the right dimensions. Remember to take measurements at different points and use the smallest to ensure accuracy. If you prefer to hang your blind in front of the recess, position it as far above as you choose, then measure the inside of the recess crosswise and add a minimum of 0.5cm to each side.

#### Outside window recess

If you're fitting your blind outside a recess, it's a matter of taste how high or low you fit it – though we recommend leaving around 10cm above the window frame or recess.

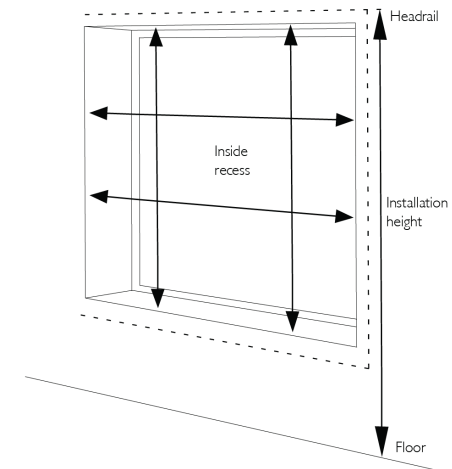

## TRIMMING THE BLIND

### 1. Marking the fabric

Slide the top and bottom bar across to allow the fabric to lay flat. Mark a line where you wish to cut the fabric.

1 2 3

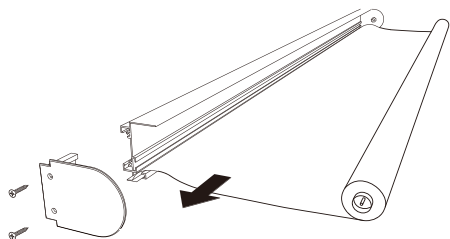
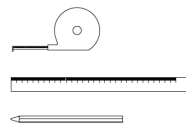

### 2. Cutting the fabric

2

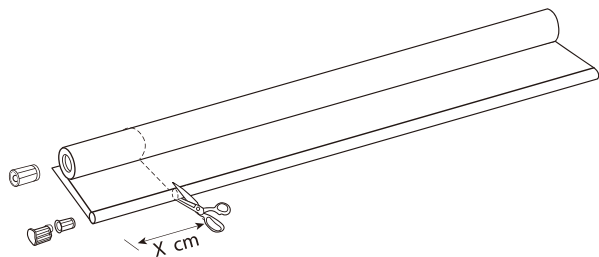
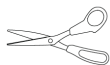

### 3. Cutting down the top and bottom bars

When cutting the top bar it is important that there is a 4mm edge of the head rail that is not covered by fabric. This will ensure that the fabric does not rub against the mechanism in use.

For blinds that sit within the recess.  
Subtract: Top bar 28mm,  
Bottom bar 32mm

1 3

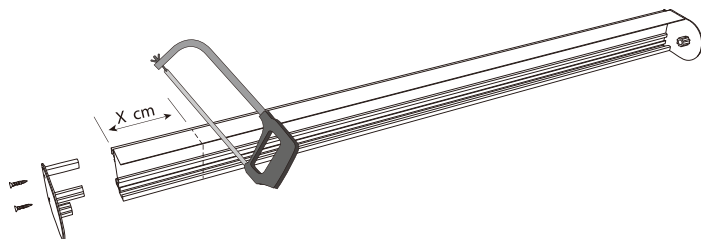

### 4. Reposition the top and bottom bar

Slot the top and bottom bar back to the correct position.

1 2 3

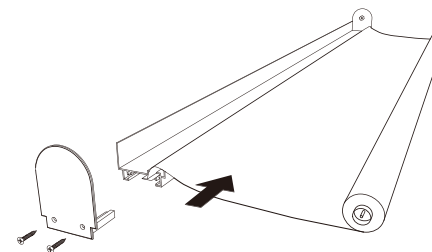

## NEXT STEP

Product assembly on following page

### 1. Drilling holes for brackets

Use the brackets as templates and mark the hole positions with a pencil. Pre-drill the holes. (For more information on wall types and fixings, see page 10).

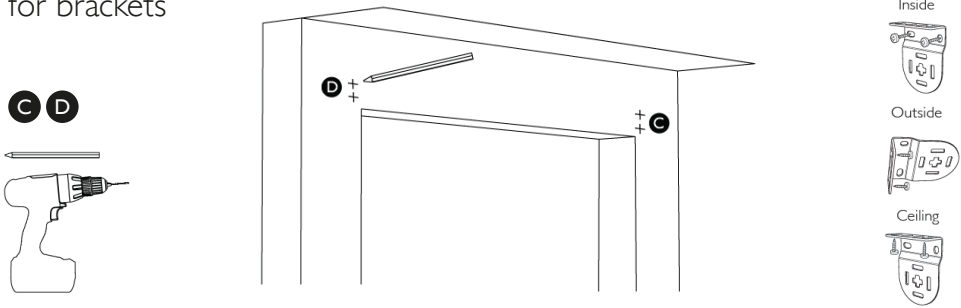

**Please note:** Additional fasteners other than those sent with your blind may be required depending on the mounting surface. Wallboard and plaster require the use of anchors such as expansion or toggle bolts. Brick, tile or stone need special plugs and drill bits. Remember to always pre-drill holes in wood to avoid splitting.

### 2. Fastening the brackets

Fasten the brackets onto the wall or ceiling and then click the covers on.

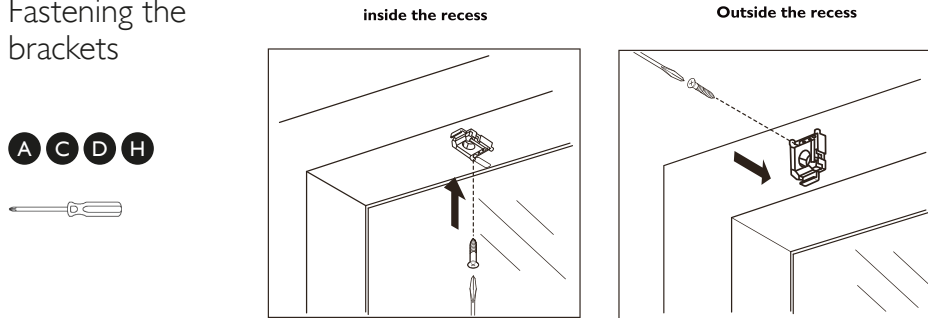

### 3. Installing the blind

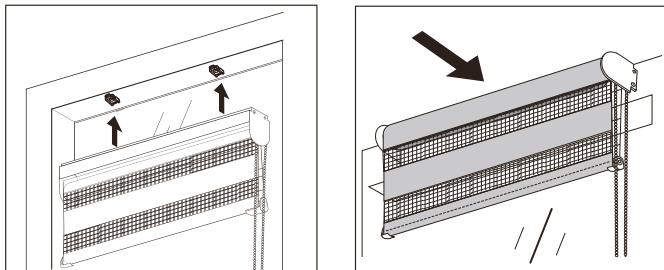

### 4. Blind Removal

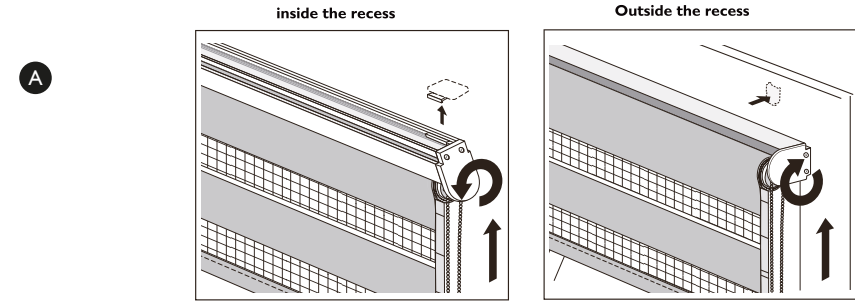

### 5. Fixing the child safety device

Mount the child safety device. Adjust the position so that the chain can slide through freely. (For more information on wall types and fixings, see page 09).

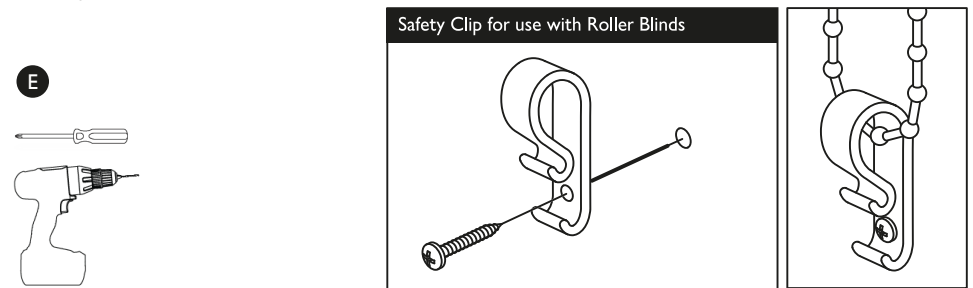

Children can strangle if a safety device is not installed. Always use a safety device to keep cords or chains out of reach of children.

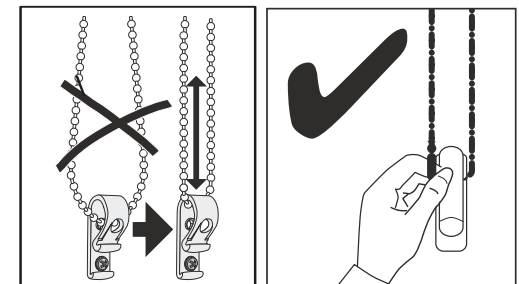

KEY INFORMATION

**Warning:** Although we have provided fixings, different wall materials require different types of screws / fixings. Please ensure you use the correct screws / fixings for your type of walls and seek professional advice if you are not sure.

Failure of the product due to incorrect fixings is the responsibility of the installer.

Please note that the screws provided with this product are suitable for a solid brick wall.

**Important** - When drilling into the walls always check that there are no hidden wires or pipes etc.

Take care when drilling on glazed tile surfaces in case the drill slips.

The safety device must be fitted securely in accordance with the assembly in step 5. It is critically important that the safety device is installed at the maximum distance possible from the control mechanism, ensuring the beaded chain is under constant tension.

This action prevents the chain becoming slack and eliminates the risk of a potential strangulation hazard.

FIXINGS

You can use one of the following types of wall plug if your walls are made of brick, breezeblock, concrete, stone or wood.

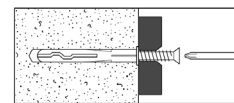

**General Purpose wall plug**

Generally aerated blocks should not be used to support heavy loads, use a specialist fitting in this case. For light loads, general – purpose wall plugs can be used.

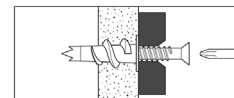

**Plasterboard wall plug**

For use when attaching light loads on to plasterboard partitions.

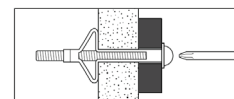

**Cavity Fixing wall plug**

For use with plasterboard partitions or hollow wooden doors.

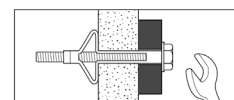

**Cavity Fixing – Heavy Duty wall plug**

For use when fitting or supporting heavy loads such as shelving, wall cabinets and coat racks.

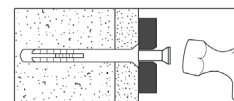

**Hammer Fixing wall plug**

For use with walls stuck with plasterboard. The hammer fixing allows it to be fixed to the wall rather than the plasterboard. Always check the fixing is secure to the retaining wall.

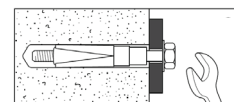

**Shield Anchor wall plug – Heavy loads**

For use with heavier loads such as TV and Hi-Fi speakers and satellite dishes etc.

PRODUCT INFORMATION

CARING FOR YOUR PRODUCT

The fabric may be dusted using a dry cloth. To clean, wipe with a barely damp cloth. The product is maintenance free however we recommend that regular checks are completed to ensure that no components have been damaged, which could result in operating difficulties or cause a safety risk.

When you unpack your new roller blind you may notice some slight waves in the fabric from packaging which will disappear when hung for a few days. Please add the bottom bar to the hem to help this process